

***Sustainability
Appraisal (SA) of the
Overton
Neighbourhood Plan***

***SA Report to accompany
the Submission version of
the Neighbourhood Plan***

July 2015



<i>Rev No</i>	<i>Comments</i>	<i>Prepared by</i>	<i>Checked by</i>	<i>Approved by</i>	<i>Date</i>
5	Submission version	Nick Chisholm-Batten Principal Consultant	Steve Smith Technical Director	Steve Smith Technical Director	30 th July 2015

Limitations

AECOM Infrastructure and Environment (“AECOM”) has prepared this Report for the use of Overton Parish Council (“the Client”) in accordance with the Agreement under which our services were performed. No other warranty, expressed or implied, is made as to the professional advice included in this Report or any other services provided by AECOM.

The conclusions and recommendations contained in this Report are based upon information provided by others and upon the assumption that all relevant information has been provided by those parties from whom it has been requested and that such information is accurate. Information obtained by AECOM has not been independently verified by AECOM, unless otherwise stated in the Report.

The methodology adopted and the sources of information used by AECOM in providing its services are outlined in this Report. The work described in this Report was undertaken between October 2014 and July 2015 and is based on the conditions encountered and the information available during the said period of time. The scope of this Report and the services are accordingly factually limited by these circumstances.

AECOM disclaim any undertaking or obligation to advise any person of any change in any matter affecting the Report, which may come or be brought to AECOM’s attention after the date of the Report.

Certain statements made in the Report that are not historical facts may constitute estimates, projections or other forward-looking statements and even though they are based on reasonable assumptions as of the date of the Report, such forward-looking statements by their nature involve risks and uncertainties that could cause actual results to differ materially from the results predicted. AECOM specifically does not guarantee or warrant any estimate or projections contained in this Report.

Copyright

© This Report is the copyright of AECOM Infrastructure and Environment.

AECOM Infrastructure and Environment
The Crescent Centre
Temple Back
Bristol BS1 6EZ
United Kingdom

Telephone: 0117 917 1200

Fax: 0117 930 0342

CONTENTS

Non-Technical Summary.....	
1 Introduction	1
1.1 Background	1
1.2 SA explained.....	3
1.3 Structure of this SA Report.....	4
2 Introduction to Part 1	7
2.1 Scope of the SA.....	7
2.2 Consultation on the scope	7
2.3 What is the plan seeking to achieve?	8
2.4 Vision and objectives for the plan.....	8
2.5 What's the plan not trying to achieve?	9
3 What's the sustainability 'context'?	10
4 What's the sustainability 'baseline'?	16
5 What are the key issues and objectives that should be a focus?	28
6 Introduction to Part 2	31
6.1 Overview of plan-making / SA work undertaken since 2013	31
6.2 Appraisal of reasonable alternatives for the Neighbourhood Plan	32
6.3 Development of Neighbourhood Plan policies	56
7 Introduction to Part 3	63
8 Appraisal of the current Submission version of the ONP Plan	63
9 Conclusions at this current stage.....	72
9.1 Potential significant effects	72
9.2 Recommendations at this current stage	73
10 Introduction to Part 4	75
10.1 Plan finalisation.....	75
Appendix I: Regulatory requirements	78
Appendix II: SA Framework.....	80

[This page is intentionally blank]

Non-Technical Summary

What is Sustainability Appraisal?

A Sustainability Appraisal (SA) has been carried out to inform the Overton Neighbourhood Plan. This has incorporated a Strategic Environmental Assessment (SEA) process as required by the SEA Regulations. Neighbourhood Groups use SA to assess Neighbourhood Plans against a set of sustainability objectives developed in consultation with interested parties. The purpose of the appraisal is to avoid adverse environmental and socio-economic effects and identify opportunities to improve the environmental quality of Overton and the quality of life of residents through the Neighbourhood Plan.

What is the Overton Neighbourhood Plan?

The Overton Neighbourhood Plan sets out a plan for Overton Parish in the period to 2029. Prepared to be in conformity with the emerging Basingstoke and Deane Local Plan, the ONP sets out a vision, objectives and a range of policies for the Overton area. These relates to a range of topics, including, but not limited to, housing, landscape, the built environment, community services, open space and transport.

The Vision for the ONP is as follows:

'Our vision for Overton

- *To conserve and enhance the things people value most about living in Overton.*
- *To do all in our power to improve the quality of life in the Parish, not only for ourselves but for future generations as well. That means everything we plan to do must be sustainable.*

Above all, we want Overton to remain a village, set in its open landscape. We therefore want to ensure that new housing has the least possible adverse impact on the features we value most, whilst welcoming newcomers to our community.

In 2030 we want Overton to continue to be a place where people of all ages and abilities can thrive, feel safe and be healthy, with opportunities to learn, work, be part of our community, take exercise, enjoy our rural landscape and heritage and lead fulfilling lives.

We want to enhance the village environment and play our part in protecting the global environment.'

It is currently anticipated that the ONP will undergo a referendum later in 2015.

Purpose of this SA Report

This SA Report, which accompanies the Submission Version of the ONP, is the third document to be produced as part of the SA process. The first document was the SA Scoping Report, which includes information about Overton's environment and community. The second document was the SA Report to accompany the consultation version of the ONP.

The purpose of the SA Report is to:

- Identify, describe and evaluate the likely significant effects of the ONP and alternatives; and
- Provide an opportunity for statutory consultees, interested parties and the public to offer views on any aspect of the SA process.

The SA Report contains:

- An outline of the contents and main objectives of the ONP and its relationship with other relevant policies, plans and programmes;
- Relevant aspects of the current state of the environment and key sustainability issues;
- The SA Framework of objectives and appraisal questions against which the ONP has been assessed;

- The appraisal of alternative approaches for the ONP;
- The likely significant effects of the ONP in environmental terms;
- The measures envisaged to prevent, reduce and as fully as possible offset any significant adverse effects as a result of the ONP; and
- The next steps for the ONP and accompanying SA process.

Assessment of alternative approaches for the ONP

A key requirement of the SEA Regulations is to appraise 'reasonable alternatives' for the ONP. To address this requirement, a number of alternative approaches have been considered in relation to the scale and form of new housing development to be taken forward through the Neighbourhood Plan. These are designed to deliver the 150 houses which Policy SS5 of the Basingstoke and Deane Local Plan specifies should be delivered in the parish to 2029.

Three sets of options were considered through the SA process as 'reasonable alternatives'. These are described below.

1) Options for number of housing sites

- Option 1: Delivery of the emerging Basingstoke and Deane Local Plan's housing allocation for the Overton area through one site.
- Option 2: Delivery of the emerging Basingstoke and Deane Local Plan's housing allocation for the Overton area through multiple sites.

2) Options for site packages

Following consultation on these two options in summer 2014, an overwhelming majority of residents preferred development on a number of sites rather than a single development. This was confirmed at the consultations in November 2014. The ONP Group therefore took an approach which spread development over a number of sites.

Eleven sites were subsequently considered for the purposes of the ONP, as follows:

Site code	Site
A	NW of Primary School
AW	Ashe Warren
B	E of Court Drove
E	E of Overton Hill Car Park
F	S of Two Gate Lane
J	W of Sapley Lane
K	W of Pond Close
M	W of Vinn's Lane
PB	Popham Beacons
WW	Willesley Warren

The sustainability merits of each of these sites were then appraised by the SA process.

Three packages of sites, or 'scenarios' were subsequently considered for the purposes of the ONP, as follows:

Scenario A

Site	Number of dwellings
Site F: S of Two Gate Lane	70
Site J: W of Sapley Lane Playing Field	55
Site B: E of Court Drove	14
Site A: NW of Primary School	5
Site WW: Willesley Warren	5
Site AW: Ashe Warren	5
Total	154

Scenario B

Site	Number of dwellings
Site F: S of Two Gate Lane	125
Site B: E of Court Drove	14
Site A: NW of Primary School	5
Site WW: Willesley Warren	5
Site AW: Ashe Warren	5
Total	154

Scenario C

Site	Number of dwellings
Combination of Site J: W of Sapley Lane Playing Field and Site K: W of Pond Close	125
Site B: E of Court Drove	14
Site A: NW of Primary School	5
Site WW: Willesley Warren	5
Site AW: Ashe Warren	5
Total	154

SA findings from the appraisal of these three options were presented (with other information related to the Neighbourhood Plan) at the consultation event undertaken for the ONP in late January 2015.

Responses on the consultation event subsequently highlighted that there was a preference for Scenario A to be taken forward as the spatial strategy for the Neighbourhood Plan.

Site D: Great North Field: This site is available but was not considered to be a reasonable alternative for the ONP. However, as the site is available, it is appraised in Part 2 of this report.

Regulation 14 consultation on the ONP: February 2015

Following further development of the plan in early 2015, an appraisal of the consultation version of the ONP was undertaken through the SA process. The appraisal was presented in an SA Report, which accompanied the 'Regulation 14' version of the Neighbourhood Plan released for consultation between February and March 2015.

Subsequently, in April and May 2015, the Neighbourhood Plan was further updated for Submission to reflect responses received during Regulation 14 consultation. Part 3 of this SA Report appraises the current Submission version of the plan.

Appraisal of the current version of the ONP

Utilising the SA Framework of objectives and appraisal questions developed during the earlier scoping stage of the SA, the SA process has appraised the policies put forward through the current Submission version of the ONP. The SA Report has presented the findings of the appraisal through eight sustainability themes, as follows:

- Biodiversity
- Climate change (including flood risk)
- Land, soil and water resources
- Historic environment and landscape
- Population and community
- Health and wellbeing
- Transportation
- Economy and enterprise

The appraisal has concluded that the current version of the ONP is likely to lead to **significant positive effects** in terms of the 'population and community' and 'health and wellbeing' sustainability objectives. These benefits largely relate to the carefully targeted spatial approach proposed by the plan, the focus on improving the quality of life of residents in the Neighbourhood Area and the ONP's impetus on protecting and enhancing open space and green infrastructure networks.

There are no brownfield sites available in the Parish, therefore in terms of potential negative effects, the development of the greenfield sites proposed through the Submission version of the ONP will lead to inevitable losses of land classified the Best and Most Versatile Agricultural Land. Whilst the ONP has sought to preserve the productivity of some of these areas through promoting allotment provision, residual **significant negative effects** are likely to remain in relation to the 'Land, Soil and Water Resources' sustainability objective.

There are also likely to be inevitable effects on landscape and townscape quality from new areas of development on the edge of Overton village. To help address this, the Submission version of the ONP presents a number of policy interventions which will help limit potential effects and achieve enhancements where possible.

In terms of potential effects on the North Wessex Downs AONB, no site allocations are located within the AONB and the Submission version of the ONP no longer takes forward two previously proposed allocations located in the AONB. Whilst there is potential for the proposed allocations to lead to potential limited effects on longer distance views from higher elevation locations in the AONB to the north, these have not been deemed to be significant.

In terms of potential effects on the River Test Site of Special Scientific Interest (SSSI), whilst many of the sites are located in relatively close proximity to the SSSI, adverse effects on this nationally designated nature conservation site are likely to be limited by the proposed size of the allocations.

Whilst the approach proposed through the Neighbourhood Plan will help initiate a range of beneficial approaches in relation to 'climate change', 'biodiversity' and 'historic environment and landscape', these are not considered as significant positive effects as the delivery of the allocations through the ONP will inevitably lead to some adverse effects in relation to these sustainability topics. For these topics therefore, the approach promoted by the current version of the ONP will limit the potential magnitude of adverse effects linked to the delivery of housing allocations in the Neighbourhood Area.

In relation to the 'economy and enterprise' sustainability objective a number of beneficial approaches are put forward by the current version of the plan. This includes relating to a promotion of the parish's visitor economy.

Recommendations for the next stages of development for the ONP

The SA Report presents the following recommendations for consideration through the implementation of the ONP:

- Due to the sensitivity of the area around Site B: E of Court Drove development at this location should be carefully managed through the implementation of the Neighbourhood Plan to ensure that the fabric and setting of these important historic environment features are not adversely affected, appropriate archaeological studies are undertaken and design and layout complements the distinctive historic setting of the area.
- To accompany the development of Site J, the provision of a convenience store.
- Two proposed site allocations located at relative distance from the services and facilities located in Overton village centre and main bus routes (Site J: W of Sapley Lane Playing Field and Site A: NW of Primary School). Development of these sites should be accompanied by the exploration of local transport infrastructure improvements, such as expansion of the 74 bus service which connects areas within the village that are not served by Stagecoach.

Next steps

The ONP has been submitted to the Local Planning Authority, Basingstoke and Deane Borough Council, for its consideration. Basingstoke and Deane Borough Council will consider whether the plan is suitable to go forward to Independent Examination in terms of the ONP meeting legal requirements and its compatibility with the Basingstoke and Deane Local Plan.

If the subsequent Independent examination is favourable, the ONP will then be subject to a referendum, organised by Basingstoke and Deane Borough Council. If more than 50% of those who vote agree with the plan, then it will be passed to Basingstoke and Deane Borough Council with a request it is adopted. Once adopted, the ONP will become part of the Development Plan for the area.

[This page is intentionally blank]

Introduction

The image features a solid green background. A bright blue diagonal stripe runs from the bottom-left corner towards the top-right corner, creating a dynamic, modern look.

1 Introduction

1.1 Background

- 1.1.1 AECOM has been commissioned to undertake an independent Sustainability Appraisal (SA) in support of Overton's emerging Neighbourhood Plan.
- 1.1.2 The Overton Neighbourhood Plan (ONP) is currently being prepared as a Neighbourhood Development Plan under the Localism Act 2012. The ONP, which covers Overton parish in Hampshire, is being prepared in the context of the emerging Basingstoke and Deane Local Plan.
- 1.1.3 This SA Report accompanies the Submission version of the ONP, which was submitted to Basingstoke and Deane Borough Council in June 2015.
- 1.1.4 Key information relating to the ONP is as follows:

Table 1.1 Key facts relating to the Overton Neighbourhood Plan

Name of Responsible Authority	Overton Parish Council
Title of Plan	Overton Neighbourhood Plan
Subject	Neighbourhood plan
Purpose	The Overton Neighbourhood Plan is being prepared as a Neighbourhood Development Plan under the Neighbourhood Planning (General) Regulations 2012. The plan will be in conformity with the Basingstoke and Deane Local Plan.
Timescale	To 2029
Area covered by the plan	Overton Parish (see Figure 1.1)
Summary of content	The Overton Neighbourhood Plan will set out a vision, strategy and range of policies for the plan area. Box 3.1 below presents the vision and aims of the Neighbourhood Plan
Plan contact point	Laura Harley, Clerk, Overton Parish Council, Oak Tree Lodge, Roundwood, Micheldever, Winchester, SO21 3BA Email address: clerk@overtonparishcouncil.gov.uk

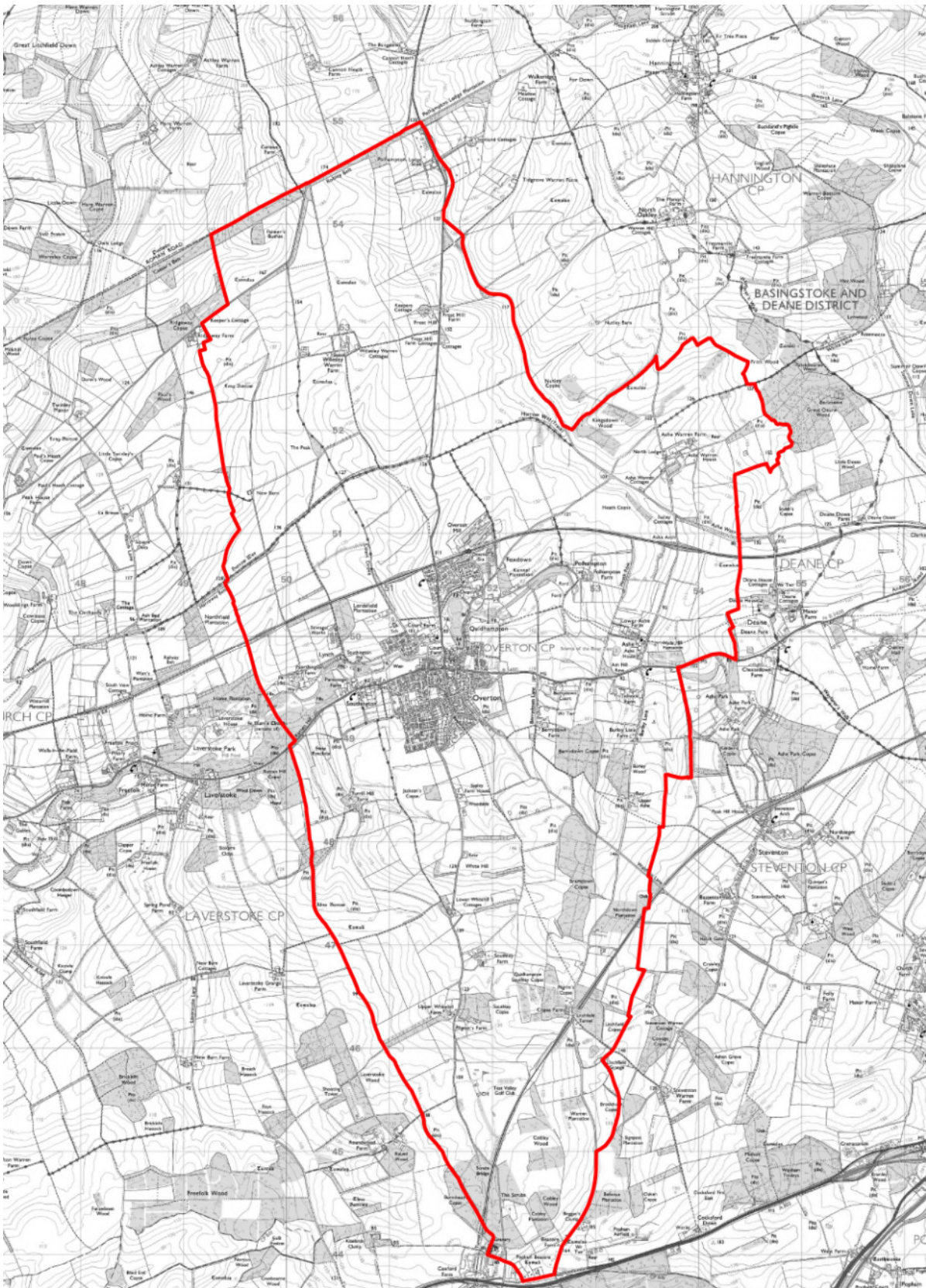

Figure 1.1 Area covered by Overton Neighbourhood Plan

1.2 SA explained

- 1.2.1 SA is a mechanism for considering and communicating the likely significant effects of an emerging plan, and reasonable alternatives in terms of key sustainability issues. The aim of SA is to inform and influence the plan-making process with a view to avoiding or mitigating negative effects and maximising positive effects. Through this approach, the SA for the ONP seeks to maximise the emerging Neighbourhood Plan's contribution to sustainable development.
- 1.2.2 SA is in line with the procedures prescribed by the Environmental Assessment of Plans and Programmes Regulations 2004 (the SEA Regulations) which transpose into national law the EU Strategic Environmental Assessment (SEA) Directive¹. It also widens the scope of the assessment from focussing on environmental issues to also include social and economic issues. SA is a legal requirement for the Basingstoke and Deane Local Plan; however Neighbourhood Development Plans do not require a SA through planning legislation.
- 1.2.3 The ONP has been determined to require SEA by Basingstoke and Deane Borough Council. To meet this requirement, the ONP is undergoing an SA process which incorporates the requirements of the SEA Regulations. This mirrors the approach currently being taken for the emerging Basingstoke and Deane Local Plan.
- 1.2.4 The SEA Regulations require that a report is published for consultation alongside the draft plan that 'identifies, describes and evaluates' the likely significant effects of implementing 'the plan, and reasonable alternatives'. The report must then be taken into account, alongside consultation responses, when finalising the plan.
- 1.2.5 In line with the SEA Regulations this report - which for the purposes of SA is known as the 'SA Report' – must essentially answer four questions:
1. What's the scope of the SA?
 2. What has Plan-making / SA involved up to this point?

Preparation of the draft plan must have been informed by at least one earlier plan-making / SA iteration. 'Reasonable alternatives' must have been appraised.
 3. What are the appraisal findings at this current stage?

i.e. in relation to the draft plan.
 4. What happens next?
- 1.2.6 These questions are derived from Schedule 2 of the SEA Regulations, which present 'the information to be provided within the report'. Table 1.1 presents the linkages between the regulatory requirements and the four SA questions.

¹ Directive 2001/42/EC

1.3 Structure of this SA Report

1.3.1 This document is the SA Report for the ONP and hence needs to answer all four of the questions listed above with a view to providing the information required by the Regulations. **Each of the four questions is answered in turn within this report, as follows:**

Table 1.1: Questions that must be answered by the SA Report in order to meet Regulatory² requirements

SA REPORT QUESTION		IN LINE WITH SCHEDULE II THE REPORT MUST INCLUDE...
Part 1: What's the scope of the SA?	What's the plan seeking to achieve?	<ul style="list-style-type: none"> An outline of the contents, main objectives of the plan and relationship with other relevant plans and programmes
	What's the sustainability 'context'?	<ul style="list-style-type: none"> The relevant environmental protection objectives, established at international or national level Any existing environmental problems which are relevant to the plan including those relating to any areas of a particular environmental importance
	What's the sustainability 'baseline'?	<ul style="list-style-type: none"> The relevant aspects of the current state of the environment and the likely evolution thereof without implementation of the plan The environmental characteristics of areas likely to be significantly affected Any existing environmental problems which are relevant to the plan including those relating to any areas of a particular environmental importance
	What are the key issues & objectives that should be a focus?	<ul style="list-style-type: none"> Key problems / issues and objectives that should be a focus of (i.e. provide a 'framework' for) appraisal
Part 2: What has plan-making / SA involved up to this point?		<ul style="list-style-type: none"> Outline reasons for selecting the alternatives dealt with (and thus an explanation of the 'reasonableness' of the approach) The likely significant effects associated with alternatives Outline reasons for selecting the preferred approach in-light of alternatives appraisal / a description of how environmental objectives and considerations are reflected in the draft plan.
Part 3: What are the appraisal findings at this current stage?		<ul style="list-style-type: none"> The likely significant effects associated with the Submission version of the plan The measures envisaged to prevent, reduce and as fully as possible offset any significant adverse effects of implementing the Submission version of the plan
Part 4: What happens next?		<ul style="list-style-type: none"> The next steps for plan making / SA process.

N.B. The right-hand column of Table 1.1 does not quote directly from Schedule II of the Regulations. Rather, it reflects a degree of interpretation. This interpretation is explained in Appendix I of this report.

² Environmental Assessment of Plans and Programmes Regulations 2004
Submission SA Report- July 2015

[This page is intentionally blank]

***Part 1: What is the
Scope of the SA?***

2 Introduction to Part 1

2.1 Scope of the SA

2.1.1 This is Part 1 of the SA Report, the aim of which is to introduce the reader to the scope of the SA. In particular, and as required by the SEA Regulations³, this Part of the SA Report answers the series of questions below.

- What's the Plan seeking to achieve?
- What's the sustainability 'context'?
- What's the sustainability 'baseline'?
- What are the key issues and objectives that should be a focus of SA?

2.1.2 This chapter answers the first question by outlining the ONP's vision and objectives.

2.1.3 The other three scoping questions are answered in **Chapters 4-5**, with each question answered for the following eight sustainability 'topics':

- | | |
|---|----------------------------|
| • Biodiversity | • Population and community |
| • Climate change (including flood risk) | • Health and wellbeing |
| • Land, soil and water resources | • Transportation |
| • Historic environment and landscape | • Economy and enterprise |

2.2 Consultation on the scope

2.2.1 The SEA Regulations require that: *"When deciding on the scope and level of detail of the information that must be included in the report, the responsible authority shall consult the consultation bodies"*. In England, the consultation bodies are Natural England, The Environment Agency and English Heritage.⁴ As such, these authorities were consulted on the scope of the ONP SA in December 2014. The Scoping Report, which was subsequently agreed by the consultation bodies as providing an appropriate 'basis' for appraisal, is available at the ONP website:

<http://www.overtonparishcouncil.gov.uk/neighbourhood-plan/>

2.2.2 Information presented in this SA Report has reflected the comments received on the Scoping Report.

³ Environmental Assessment of Plans and Programmes Regulations 2004

⁴ In-line with Article 6(3).of the SEA Directive, these consultation bodies were selected because *'by reason of their specific environmental responsibilities,[they] are likely to be concerned by the environmental effects of implementing plans and programme.'*

2.3 What is the plan seeking to achieve?

- 2.3.1 The ONP is currently being developed as a Neighbourhood Development Plan under the Localism Act 2012. The Neighbourhood Plan was submitted to Basingstoke and Deane Council in July 2015.
- 2.3.2 The ONP is being prepared in the context of the emerging Basingstoke and Deane Local Plan 2011-2029. The Local Plan is currently undergoing Examination and is anticipated to be adopted in 2015. It will, when adopted provide a framework for how future development across the borough will be planned and delivered.
- 2.3.3 The Local Plan identifies 150 dwellings to be delivered in Overton by 2029; however it does not identify where these should be located. The ONP therefore provides an opportunity for meeting the community aspirations of Overton whilst also helping to deliver the Local Plan's main objectives for the Neighbourhood Area.

2.4 Vision and objectives for the plan

- 2.4.1 The vision and objectives for the ONP were developed following the review of extensive consultation exercises carried out by the Parish Council and the Neighbourhood Plan Steering Group. The vision and objectives for the ONP are presented in Box 3.1.

Box 3.1: Vision and objectives of the Overton Neighbourhood Plan

Vision

'Our vision for Overton

- *To conserve and enhance the things people value most about living in Overton.*
- *To do all in our power to improve the quality of life in the Parish, not only for ourselves but for future generations as well. That means everything we plan to do must be sustainable.*

Above all, we want Overton to remain a village, set in its open landscape. We therefore want to ensure that new housing has the least possible adverse impact on the features we value most, whilst welcoming newcomers to our community.

In 2030 we want Overton to continue to be a place where people of all ages and abilities can thrive, feel safe and be healthy, with opportunities to learn, work, be part of our community, take exercise, enjoy our rural landscape and heritage and lead fulfilling lives.

We want to enhance the village environment and play our part in protecting the global environment.'

Objectives

Landscape, the built environment and local distinctiveness

- LBE1 To conserve views within the village and to the open countryside
- LBE2 New developments must fit into the context in terms of design and location contributing to the character of the village

Housing

- H1 New housing will respond to the needs of local residents
- H2 New housing will be phased in a series of small developments over the plan period
- H3 New housing will be sustainable and efficiently conserve natural resources, restrict pollution and promote biodiversity
- H4 Housing developments must be fully supported by adequate infrastructure.

Working

- W1 To encourage proposals leading to more local jobs for local people.
- W2 To support local employment by making the village more attractive to tourists and visitors.

Shops and services

- S1 To support shops and services in the parish.

Learning and skills

- L1 To support life-long learning.

Getting around

- T1 To encourage walking and cycling and the use of public transport and reduce reliance on cars.
- T2 To improve provision of parking facilities in the village and at Overton Station.

Community services

- C1 To ensure that our community services continue to meet the needs of an expanding and ageing population.

Enjoyment and recreation

- E1 To support social, sporting and recreational facilities in the village for people of all ages and abilities.
- E2 To work with statutory bodies to protect the Conservation Area, the River Test Site of Special Scientific Interest, land near the river which is part of the Test Valley Environmentally Sensitive Area, the Sites of Importance for Nature Conservation (SINCs) and land north of the London to Exeter railway which is part of the North Wessex Downs Area of Outstanding Natural Beauty
- E3 To encourage access to the countryside and riverside for walkers and the use of these facilities.

2.4.2 For each of these objectives, the ONP sets out a number of Neighbourhood Plan policies. The latest iteration (February 2015) of these policies has been appraised in Chapter 8 of this SA Report.

2.5 What's the plan not trying to achieve?

2.5.1 It is important to emphasise that the plan is strategic in nature. Even the allocation of sites should be considered a strategic undertaking, i.e. a process that omits consideration of some detailed issues in the knowledge that these can be addressed further down the line (through the planning application process). The strategic nature of the plan is reflected by the scope of the SA.

3 What's the sustainability 'context'?

The SA Report must include...

- The relevant sustainability objectives, established at international / national level
- Any existing sustainability problems / issues which are relevant to the plan including, in particular, those relating to any areas / populations etc. of particular importance

3.1 Introduction

3.1.1 An important step when seeking to establish the appropriate 'scope' of an SA involves reviewing 'sustainability context' messages. From the SEA Regulations it is understood that there is a need to focus on context messages relating to:

3.1.2 Broad problems / issues; and

- Objectives
- i.e. 'things that are aimed at or sought'.

3.1.3 Set out below is a summary and update to the context review presented within the December 2014 Scoping Report.

3.2 Biodiversity

3.2.1 At the European level, the EU Biodiversity Strategy⁵ was adopted in May 2011 in order to deliver an established new Europe-wide target to 'halt the loss of biodiversity and the degradation of ecosystem services in the EU by 2020'.

3.2.2 Key messages from the National Planning Policy Framework (NPPF) include:

- Contribute to the Government's commitment to halt the overall decline in biodiversity by minimising impacts and achieving net gains in biodiversity wherever possible.
- Promote the 'preservation, restoration and recreation of priority habitats, ecological networks' and the 'protection and recovery of priority species'. Plan for biodiversity at a landscape-scale across local authority boundaries.
- Set criteria based policies for the protection of internationally, nationally and locally designated sites, giving weight to their importance not just individually but as a part of a wider ecological network.
- Take account of the effects of climate change in the long term. Adopt proactive strategies to adaptation and manage risks through adaptation measures including green infrastructure (i.e. 'a network of multi-functional green space, urban and rural, which is capable of delivering a wide range of environmental and quality of life benefits for local communities').
- Plan positively planning for 'green infrastructure' as part of planning for 'ecological networks'.
- High quality open spaces should be protected or their loss mitigated, unless a lack of need is established.
- The Natural Environment White Paper (NEWP)⁶ sets out the importance of a healthy, functioning natural environment to sustained economic growth, prospering communities and personal well-being. It was in part a response to the UK's failure to halt and reverse the decline in biodiversity by 2010 and it signalled a move away from the traditional approach of protecting biodiversity in nature reserves to adopting a landscape approach to protecting and enhancing biodiversity.

⁵ European Commission (2011) Our life insurance, our natural capital: an EU biodiversity strategy to 2020 [online] available at: http://ec.europa.eu/environment/nature/biodiversity/comm2006/pdf/2020/1_EN_ACT_part1_v7%5b1%5d.pdf

⁶ Defra (2012) The Natural Choice: securing the value of nature (Natural Environment White Paper) [online] available at: <http://www.official-documents.gov.uk/document/cm80/8082/8082.pdf>

- 3.2.3 At the local level the Biodiversity Action Plan for Hampshire reviews the status of wildlife in Hampshire and sets out a framework for action in two parts.
- 3.2.4 Volume One, the Strategic Plan, sets out the objectives of the Partnership, describes Hampshire's biodiversity, and identifies habitats and species of priority concern. It also presents a strategy for information, data and raising awareness of biodiversity. Volume Two contains individual action plans for priority habitats and species and topics that have a considerable influence on the conservation of biodiversity.

3.3 Climate change

- 3.3.1 In its 2007 strategy on climate change, the European Commission assesses the costs and benefits of combating climate change and recommends a package of measures to limit global warming to 2° Celsius.⁷ In relation to energy, the Commission recommends that the EU's energy efficiency improves by 20% and the share of renewable energy grows to 20% by 2020.
- 3.3.2 Key messages from the National Planning Policy Framework (NPPF) include:
- Support the transition to a low carbon future in a changing climate as a 'core planning principle'.
 - There is a key role for planning in securing radical reductions in greenhouse gases (GHG), including in terms of meeting the targets set out in the Climate Change Act 2008⁸. Specifically, planning policy should support the move to a low carbon future through:
 - planning for new development in locations and ways which reduce GHG emissions;
 - actively supporting energy efficiency improvements to existing buildings;
 - setting local requirements for building's sustainability in a way that is consistent with the Government's zero carbon buildings policy;
 - positively promoting renewable energy technologies and considering identifying suitable areas for their construction; and
 - encouraging those transport solutions that support reductions in greenhouse gas emissions and reduce congestion.
 - Direct development away from areas highest at risk of flooding, with development 'not to be allocated if there are reasonably available sites appropriate for the proposed development in areas with a lower probability of flooding'. Where development is necessary, it should be made safe without increasing levels of flood risk elsewhere.
 - Take account of the effects of climate change in the long term, taking into account a range of factors including flooding. Adopt proactive strategies to adaptation and manage risks through adaptation measures including well planned green infrastructure.
- 3.3.3 The Flood and Water Management Act⁹ highlights that alternatives to traditional engineering approaches to flood risk management include:
- Incorporating greater resilience measures into the design of new buildings, and retro-fitting properties at risk (including historic buildings)
 - Utilising the environment in order to reduce flooding, for example through the management of land to reduce runoff and through harnessing the ability of wetlands to store water
 - Identifying areas suitable for inundation and water storage to reduce the risk of flooding elsewhere
 - Planning to roll back development in coastal areas to avoid damage from flooding or coastal erosion

⁷ Commission of the European Communities (2007) Limiting Global Climate Change to two degrees Celsius: The way ahead for 2020 and beyond [online] available at: <http://eur-lex.europa.eu/LexUriServ/LexUriServ.do?uri=COM:2007:0002:FIN:EN:PDF>

⁸ The Climate Change Act 2008 sets targets for greenhouse gas (GHG) emission reductions through action in the UK of at least 80% by 2050, and reductions in CO₂ emissions of at least 26% by 2020, against a 1990 baseline.

⁹ Flood and Water Management Act (2010) [online] available at: <http://www.legislation.gov.uk/ukpga/2010/29/contents>

- Creating sustainable drainage systems (SuDS)¹⁰

3.3.4 Further guidance is provided in the document Planning for SuDS.¹¹ This report calls for greater recognition of the multiple benefits that water management can present. It suggests that successful SuDS are capable of 'contributing to local quality of life and green infrastructure'.

3.4 Historic environment and landscape

3.4.1 Key messages from the National Planning Policy Framework (NPPF) include:

- Protect and enhance valued landscapes, giving particular weight to those identified as being of national importance.
- Heritage assets should be recognised as an 'irreplaceable resource' that should be conserved in a 'manner appropriate to their significance', taking account of 'the wider social, cultural, economic and environmental benefits' of conservation, whilst also recognising the positive contribution new development can make to local character and distinctiveness.
- Set out a 'positive strategy' for the 'conservation and enjoyment of the historic environment', including those heritage assets that are most at risk.
- Consider the effects of climate change in the long term, including in terms of landscape. Adopt 'proactive strategies' to adaptation and manage risks through adaptation measures including well planned green infrastructure.

3.4.2 The Government's Statement on the Historic Environment for England¹² sets out its vision for the historic environment. It calls for those who have the power to shape the historic environment to recognise its value and to manage it in an intelligent manner in light of the contribution that it can make to social, economic and cultural life.

3.4.3 The Consultation Draft of the North Wessex Downs AONB Management Plan 2014-2019 sets out a wide ranging vision for the AONB, incorporating aspects such as landscape quality and tranquillity; the protection and enhancement of the historic environment; the conservation and improvement of biodiversity, water and soil quality; the development of vibrant economy based on the area's environmental qualities; thriving rural communities; and sustainable tourism. The Management Plan subsequently presents a series of policies and objectives to achieve this vision in the AONB, and proposes a Delivery Plan of actions.

3.5 Land, soil and water resources

3.5.1 The EU's Soil Thematic Strategy¹³ presents a strategy for protecting soils resources in Europe. The main aim of the strategy is to minimise soil degradation and limit associated detrimental effects linked to water quality and quantity, human health, climate change, biodiversity, and food safety.

3.5.2 The Water Framework Directive drives a catchment-based approach to water management. In England and Wales there are 100 water catchments and it is Defra's intention is to establish a 'framework for integrated catchment management' across England. The Environment Agency is currently seeking to establish 'Significant Water Management Issues' within catchments with a view to presenting second River Basin Management Plans to ministers in 2015. The plans will seek to deliver the objectives of the WFD namely:

- Enhance the status and prevent the further deterioration of aquatic ecosystems and associated wetlands which depend on aquatic ecosystems;

¹⁰ N.B. The provisions of Schedule 3 to the Flood and Water Management Act 2010 came into force on the 1st of October 2012 and makes it mandatory for any development in England or Wales to incorporate SuDs.

¹¹ CIRIA (2010) Planning for SuDS – making it happen [online] available at: <http://www.ciria.org/service/knowledgebase/AM/ContentManagerNet/ContentDisplay.aspx?Section=knowledgebase&NoTemplate=1&ContentID=18465>

¹² HM Government (2010) The Government's Statement on the Historic Environment for England [online] available at: http://webarchive.nationalarchives.gov.uk/+http://www.culture.gov.uk/reference_library/publications/6763.aspx

¹³ European Commission (2006) Soil Thematic Policy [online] available at: http://ec.europa.eu/environment/soil/index_en.htm

- Promote the sustainable use of water;
- Reduce the pollution of water, especially by ‘priority’ and ‘priority hazardous’ substances; and
- Ensure the progressive reduction of groundwater pollution.

3.5.3 Key messages from the National Planning Policy Framework (NPPF) include:

- Protect and enhance soils. The value of best and most versatile agricultural land should also be taken into account.
- Prevent new or existing development from being ‘adversely affected’ by the presence of ‘unacceptable levels’ of soil pollution or land instability and be willing to remediate and mitigate ‘despoiled, degraded, derelict, contaminated and unstable land, where appropriate’.
- Encourage the effective use of land’ through the reuse of land which has been previously developed, ‘provided that this is not of high environmental value’. Whilst there is no longer a national requirement to build at a minimum density, the NPPF requires local planning authorities to ‘set out their own approach to housing density to reflect local circumstances’.
- Produce strategic policies to deliver the provision of a variety of infrastructure, including that necessary for water supply
- With regards to waste, the NPPF does not contain any specific waste policies as waste planning policy will be published as part of the National Waste Management Plan.

3.5.4 Other key documents at the national level include Safeguarding our Soils: A strategy for England¹⁴, which sets out a vision for soil use in England, and the Water White Paper¹⁵, which sets out the Government’s vision for a more resilient water sector. It states the measures that will be taken to tackle issues such as poorly performing ecosystems, and the combined impacts of climate change and population growth on stressed water resources. In terms of waste management, the Government Review of Waste Policy in England¹⁶ recognises that environmental benefits and economic growth can be the result of a more sustainable approach to the use of materials.

3.6 Population and community

3.6.1 Key messages from the National Planning Policy Framework (NPPF) include:

- To ‘boost significantly the supply of housing’, local planning authorities should meet the ‘full, objectively assessed need for market and affordable housing’ in their area. They should prepare a Strategic Housing Market Assessment to assess their full housing needs, working with neighbouring authorities where housing market areas cross administrative boundaries. The Strategic Housing Market Assessment should identify the scale and mix of housing and the range of tenures that the local population is likely to need over the plan period.
- With a view to creating ‘sustainable, inclusive and mixed communities’ authorities should ensure provision of affordable housing onsite or externally where robustly justified.
- In rural areas, when exercising the duty to cooperate with neighbouring authorities, local planning authorities should be responsive to local circumstances and plan housing development to reflect local needs, particularly for affordable housing, including through rural exception sites where appropriate. Authorities should consider whether allowing some market housing would facilitate the provision of affordable housing to meet local needs.
- The NPPF attaches great importance to the design of the built environment. It explains how good design is a key aspect in sustainable development, and how development should improve the quality of the area over its lifetime, not just in the short term. Good architecture and landscaping are important, with the use of design codes contributing to the delivery of

¹⁴ Defra (2009) Safeguarding our Soils: A strategy for England [online] available at: <http://archive.defra.gov.uk/environment/quality/land/soil/documents/soil-strategy.pdf>

¹⁵ Defra (2011) Water for life (The Water White Paper) [online] available at <http://www.official-documents.gov.uk/document/cm82/8230/8230.pdf>

¹⁶ Defra (2011) Government Review of Waste Policy in England [online] available at: <http://www.defra.gov.uk/publications/files/pb13540-waste-policy-review110614.pdf>

high quality outcomes. Design should reinforce local distinctiveness, raise the standard more generally in the area and address the connections between people and places.

- The social role of the planning system involves ‘supporting vibrant and healthy communities’.
- The planning system can play an important role in facilitating social interaction and creating healthy, inclusive communities
- Promote the retention and development of local services and community facilities such as local shops, meeting places, sports venues, cultural buildings, public houses and places of worship.
- Ensure that developments create safe and accessible environments where crime and disorder, and the fear of crime, do not undermine quality of life or community cohesion. Places should contain clear and legible pedestrian routes, and high quality public spaces, which encourage the active and continual use of public areas.
- Ensuring that there is a ‘sufficient choice of school places’ is of ‘great importance’ and there is a need to take a ‘proactive, positive and collaborative approach’ to bringing forward ‘development that will widen choice in education’.

3.7 Health and wellbeing

3.7.1 Key messages from the National Planning Policy Framework (NPPF) include:

- The social role of the planning system involves ‘supporting vibrant and healthy communities’.
- A core planning principle is to ‘take account of and support local strategies to improve health, social and cultural wellbeing for all’.
- The planning system can play an important role in facilitating social interaction and creating healthy, inclusive communities’
- Promote the retention and development of local services and community facilities such as local shops, meeting places, sports venues, cultural buildings, public houses and places of worship.
- Set out the strategic policies to deliver the provision of health facilities.
- Access to high quality open spaces and opportunities for sport and recreation can make an important contribution to the health and well-being of communities.
- Planning policies should aim to avoid noise from giving rise to significant adverse impacts on health and quality of life.

3.7.2 In relation to other key national messages in relation to health, Fair Society, Healthy Lives¹⁷ (‘The Marmot Review’) investigated health inequalities in England and the actions needed in order to tackle them. Subsequently, a supplementary report was prepared providing additional evidence relating to spatial planning and health on the basis that that there is: ‘overwhelming evidence that health and environmental inequalities are inexorably linked and that poor environments contribute significantly to poor health and health inequalities’.

3.7.3 The increasing role that local level authorities are expected to play in producing health outcomes is demonstrated by recent Government legislation. The Health and Social Care Act 2012 transfers responsibility for public health from the NHS to local government¹⁸, giving local authorities a duty to improve the health of the people who live in their areas. This will require a more holistic approach to health across all local government functions.

3.8 Transportation

3.8.1 European and UK transport policies and plans place emphasis on the modernisation and sustainability of the transport network. Specific objectives include reducing pollution and road congestion through improvements to public transport, walking and cycling networks and reducing the

¹⁷ The Marmot Review (2011) The Marmot Review: Implications for Spatial Planning [online] available at: <http://www.nice.org.uk/nicemedia/live/12111/53895/53895.pdf>

¹⁸ Upper tier and unitary local authorities

need to travel. National policy also focuses on the need for the transport network to support sustainable economic growth. The Hampshire Local Transport Plan 2011-31 presents a long term strategy for the area and an implementation plan for the county.

3.9 Economy and enterprise

3.9.1 Key messages from the National Planning Policy Framework (NPPF) include:

- The planning system can make a contribution to building a strong, responsive economy by 'ensuring that sufficient land of the right type is available in the right places and at the right time to support growth and innovation; and by identifying and coordinating development requirements, including the provision of infrastructure'.
- Capitalise on 'inherent strengths', and to meet the 'twin challenges of global competition and of a low carbon future'.
- Support new and emerging business sectors, including positively planning for 'clusters or networks of knowledge driven, creative or high technology industries'.
- Support competitive town centre environments.
- Edge of town developments should only be considered where they have good access. This should be followed with an impact assessment to ensure the town centre remains viable in the long term.
- Enhance and retain markets is also outlined.
- Support the sustainable growth and expansion of all types of business and enterprise in rural areas and promote the development and diversification of agricultural and other land-based rural businesses.

4 What's the sustainability 'baseline'?

The SA Report must include...

- The relevant aspects of the current state of the sustainability baseline and the likely evolution thereof without implementation of the plan'
- The characteristics of areas / populations etc. likely to be significantly affected.
- Any existing sustainability problems / issues which are relevant to the plan including, in particular, those relating to any areas / populations etc. of particular importance

4.1 Introduction

- 4.1.1 The baseline review tailors and develops the problems/issues identified through context review so that they are locally specific. A detailed understanding of the baseline can aid the identification and evaluation of 'likely significant effects' associated with the plan / alternatives.
- 4.1.2 Set out below is a summary and update to the baseline review presented within the December 2014 Scoping Report.

4.2 Biodiversity

Summary of current baseline

- 4.2.1 No sites internationally designated for their nature conservation interest are present in the Neighbourhood Area. The closest European designated site is the River Itchen SAC, which is approximately 11km to the south of the Neighbourhood Area.
- 4.2.2 In terms of nationally designated nature conservation sites, two Sites of Special Scientific Interest (SSSI) are present in the Neighbourhood Area.
- 4.2.3 The River Test passes through the centre of the parish in an east to west direction. The river has been designated as an SSSI for its interest as one of the most species-rich lowland rivers in England¹⁹.
- 4.2.4 The condition assessment for the River Test SSSI undertaken in February 2013 deemed that a main part of the SSSI within the Neighbourhood Area (comprising the river channel) is in an 'unfavourable no change' condition. This is due to the SSSI units not complying with existing river profile or river planform targets, and failing the targets for river bank vegetation and the target for the presence of non-native plant species²⁰. The area of the SSSI comprising neutral grassland west of Southington has been assessed as being in an 'unfavourable recovering' condition due to low water levels and inappropriate scrub control²¹.
- 4.2.5 Reflecting the presence of the River Test SSSI in the central areas of Overton village, a significant part of the built up area of the Neighbourhood Area is within the SSSI's Impact Risk Zone²² for the types of development likely to be proposed through the Neighbourhood Plan.
- 4.2.6 One further SSSI is located in far the south of the Neighbourhood Area, the Micheldever Spoil Heaps SSSI. The 32ha site comprises 19th century chalk spoil heaps, derived from railway cuttings, which

¹⁹ River Test SSSI citation: http://www.sssi.naturalengland.org.uk/citation/citation_photo/2000170.pdf

²⁰ River Test - river channel unit - source to Bourne: <http://designatedsites.naturalengland.org.uk/UnitDetail.aspx?UnitId=1027757> [accessed 5th November 2014]

²¹ <http://designatedsites.naturalengland.org.uk/UnitDetail.aspx?UnitId=1027724>

²² SSSI Impact Risk Zones are a GIS tool/dataset which maps zones around each SSSI according to the particular sensitivities of the features for which it is notified. They specify the types of development that have the potential to have adverse impacts at a given location. Natural England is a statutory consultee on development proposals that might impact on SSSIs.

exhibit various stages of colonisation by a range of plant communities. The site has been designated for its exceptional botanical importance.

- 4.2.7 The SSSI has been assessed as being in an 'unfavourable recovering' condition due to a lack of corrective works and inappropriate scrub control.²³
- 4.2.8 The Hampshire Biodiversity Action Plan (BAP) identifies a number of 'priority habitats' that are characteristic of Hampshire and for which Hampshire makes a significant contribution to the UK aims of the Biodiversity Action Plan.
- 4.2.9 Key areas of BAP Priority Habitat in the Neighbourhood Area include: Deciduous Woodland and Coastal and Floodplain Grazing Marsh BAP Priority Habitat along and close to the River Test; numerous areas of Deciduous Woodland BAP Priority Habitat scattered across the south east of the plan area; small areas of Lowland Meadows BAP Priority Habitat in the south of the Neighbourhood Area, including at Quidhampton Southley Copse; and a number of areas of Traditional Orchard BAP Priority Habitat in the vicinity of Overton village. Many of the areas covered by Deciduous Woodland BAP Priority Habitat have also been classified as ancient woodland.
- 4.2.10 Sites of Interest for Nature Conservation (SINCs) are sites locally designated for their habitat and/or species interest by the Hampshire Biodiversity Information Centre (HBIC) against a set of agreed criteria. There are 22 SINCs present in the Neighbourhood Area. HBIC also holds survey records for approximately ten further sites of nature conservation interest which have not been designated.²⁴
- 4.2.11 In relation to geodiversity, the underlying rocks of the parish form part of the Hampshire Basin, a geological feature in which the rocks slope gently from the north to the south. The oldest rock in the Neighbourhood Area is Cretaceous chalk which was formed over 65 million years ago. This chalk is a porous, porous, fine grained limestone which is generally highly permeable and alkaline.²⁵

Summary of future baseline

- 4.2.12 Sites of biodiversity importance have the potential to come under increasing pressures from an increase in the plan area's population and associated development. This includes through a loss of habitats and impacts on biodiversity networks. This may be exacerbated by the effects of climate change, which has the potential to lead to changes in the distribution and abundance of species and changes to the composition and character of habitats. In view of the location of the River Test within Overton village, the River Test SSSI is particularly sensitive.
- 4.2.13 Biodiversity in the plan area has the potential to continue to be affected by the economic necessity for intensive farming in the area (as facilitated by the presence of high quality of agricultural land in the plan area). There is however the potential for gains for biodiversity in the farmed landscape to arise as a result of the New Environmental Land Management Scheme (NELMS), which is currently being implemented.
- 4.2.14 Benefits for biodiversity have the potential to arise from the increasing integration of biodiversity considerations within forward planning in Basingstoke and Deane and Hampshire and efforts to improve green infrastructure networks in the area.

²³ Micheldever Spoil Heaps SSSI citation:

<http://designatedsites.naturalengland.org.uk/SiteDetail.aspx?SiteCode=S1001316&SiteName=Micheldever&countyCode=&responsiblePerson=>

²⁴ Information from Overton Parish Biodiversity Action Plan

²⁵ Information from Overton Parish Biodiversity Action Plan

4.3 Climate change

Summary of current baseline

4.3.1 The outcome of research on the probable effects of climate change in the UK was released in 2009 by the UK Climate Projections (UKCP09) team²⁶. UKCP09 gives climate information for the UK up to the end of this century and projections of future changes to the climate are provided, based on simulations from climate models. Projections are broken down to a regional level across the UK and are shown in probabilistic form, which illustrate the potential range of changes and the level of confidence in each prediction.

4.3.2 As highlighted by the research, the effects of climate change for the South East by 2050 for a medium emissions scenario²⁷ are likely to be as follows:

- the central estimate of increase in winter mean temperature is 2.2°C and an increase in summer mean temperature of 2.8°C; and
- the central estimate of change in winter mean precipitation is 16% and summer mean precipitation is –19%.

4.3.3 Resulting from these changes, a range of risks may exist for the Overton Neighbourhood Area. These include:

- increased incidence of heat related illnesses and deaths during the summer;
- increased incidence of illnesses and deaths related to exposure to sunlight (e.g. skin cancer, cataracts);
- increased incidence of pathogen related diseases (e.g. legionella and salmonella);
- increase in health problems related to rise in local ozone levels during summer;
- increased risk of injuries and deaths due to increased number of storm events;
- effects on water resources from climate change;
- reduction in availability of groundwater for abstraction;
- adverse effect on water quality from low stream levels and turbulent stream flow after heavy rain;
- increased risk of flooding, including increased vulnerability to 1:100 year floods;
- changes in insurance provisions for flood damage;
- a need to increase the capacity of wastewater treatment plants and sewers;
- a need to upgrade flood defences;
- soil erosion due to flash flooding;
- loss of species that are at the edge of their southerly distribution;
- spread of species at the northern edge of their distribution;
- deterioration in working conditions due to increased temperatures;
- changes to global supply chain;
- increased difficulty of food preparation, handling and storage due to higher temperatures;
- an increased move by the insurance industry towards a more risk-based approach to insurance underwriting, leading to higher cost premiums for business;
- increased demand for air-conditioning;
- increased drought and flood related problems such as soil shrinkages and subsidence;
- risk of road surfaces melting more frequently due to increased temperature; and
- flooding of roads.

²⁶ The data was released on 18th June 2009: See: <http://ukclimateprojections.defra.gov.uk/>

²⁷ UK Climate Projections (2009) South East 2050s Medium Emissions Scenario [online] available at: <http://ukclimateprojections.metoffice.gov.uk/22290> (accessed 11/2014)

4.3.4 In terms of flood risk, groundwater and, to a lesser extent, fluvial flooding are issues for the Neighbourhood Area. This includes related to the presence of the chalk aquifer under the parish and the presence of the River Test. Key areas at risk of flooding include Southington, Glebe Meadow and Bridge Street.

4.3.5 The Basingstoke and Deane Strategic Flood Risk Assessment²⁸ summarises flood risk in Overton as follows:

'The floodplain of the River Test runs through the town. There are some properties within the floodplain, but in general there seems to be adequate green space around the river to accommodate the floodplain – further development should avoid encroaching on this area. There are three instances of flooding from the drainage system; all of these are close to the river so may be partly due to backing up at high water level. A potential susceptibility to groundwater flooding is indicated in the groundwater emergence maps.'

4.3.6 In relation to greenhouse gas emissions, source data from the Department of Energy and Climate Change²⁹ suggests that Basingstoke and Deane borough has had consistently higher per capita emissions than for Hampshire, the South East and England since 2005. The borough has also seen smaller reductions in emissions per capita between 2005 and 2012 (16.5%) compared to Hampshire (23.3%), the South East (18.3%) and England (a 17.7% reduction).

4.3.7 In relation to CO₂ emissions by end user, between 2005 and 2012 the proportion of emissions originating from industrial and commercial sources in the borough rose fell slightly from 34% to 32%. In the same period the proportion of total emissions from domestic sources increased slightly from 25% to 27% and road transport remained the same.

Summary of future baseline

4.3.8 Climate change has the potential to increase the occurrence of extreme weather events in the Neighbourhood Area, with increases in mean summer and winter temperatures, increases in mean precipitation in winter and decreases in mean precipitation in summer. This is likely to increase the risks associated with climate change (including surface water flooding) with an increased need for resilience and adaptation.

4.3.9 In terms of climate change mitigation, per capita emissions are likely to continue to decrease as energy efficiency measures, renewable energy production and new technologies become more widely adopted. However road transport and domestic sources are likely to be increasing contributors proportionally.

4.4 Historic environment and landscape

Summary of current baseline

4.4.1 The northern part of the Neighbourhood Area (north of the railway line) falls within the North Wessex Downs Area of Outstanding Natural Beauty (AONB). The primary purpose of AONB designation is 'conserving and enhancing the natural beauty of the area'. In this context the North Wessex Downs AONB was designated for its dramatic, undeveloped and locally distinct chalk downlands with extensive areas of semi-natural chalk grassland, interspersed with well-wooded plateaux, arable lands and secluded valleys. The part of the Neighbourhood Area within the AONB has been classified by the AONB Management Plan as 'Downland with Woodland'.

²⁸ Halcrow (January 2010) Basingstoke and Deane Borough Council Strategic Flood Risk Assessment for Local Development Framework

²⁹ Department of Energy and Climate Change (2011) Official statistics: Local Authority carbon dioxide emissions [online] available at: <https://www.gov.uk/government/publications/local-authority-emissions-estimates> (accessed on 20/01/2015)

- 4.4.2 The Neighbourhood Area has a rich historic environment. A number of features and areas for the historic environment in the plan area are recognised through historic environment designations. These include listed buildings and scheduled monuments, which are nationally designated, and conservation areas, which are designated at the local level. English Heritage is the statutory consultee for certain categories of listed building consent and all applications for scheduled monument consent. The historic environment is protected through the planning system, via conditions imposed on developers and other mechanisms.
- 4.4.3 There is one conservation area located within the plan area: the Overton Conservation Area, which was designated in 1971. Whilst the original designation related only to the medieval core of the village, located to the south of the River Test, the conservation area boundary was extended in 1987 to encompass St Mary's Church and Court Farm, the settlements of Southington to the south-west, and Quidhampton and Polhampton to the north-east. All are linked to Overton by the river, visually and historically. A Conservation Area Appraisal was prepared in 2003³⁰.
- 4.4.4 The Neighbourhood Area contains numerous listed buildings. In this context the parish includes three Grade I listed structures at Berrydown Court, four Grade II* listed building (Barn to the South of South Litchfield Grange, the Chapel at Quidhampton, the Church of St Mary and Court Farmhouse), and 50 Grade II listed buildings.
- 4.4.5 Scheduled monuments are sites of national importance and protected by the Ancient Monuments and Archaeological Areas Act 1979. According to the National Heritage List for England, there are six scheduled monuments in the Neighbourhood Area, comprising long and round barrows and a cemetery. There is part of one registered park and garden in the parish, (Laverstoke Park) and no historic battlefields.
- 4.4.6 According to the Overton element of the Extensive Urban Survey³¹, two areas of High Archaeological Importance have been identified in Overton village. These include:
- the burgage plots along both sides of Winchester Street and the possible burgage plots along the north side of the High Street; and
 - in the vicinity of the church and Court Farm.
- 4.4.7 The same study identified Areas of Archaeological Importance to the south of Winchester Street and along the western part of High Street.
- 4.4.8 Since 2008, English Heritage has released an annual Heritage at Risk Register. The Heritage at Risk Register highlights the Grade I and Grade II* listed buildings, and scheduled monuments, conservation areas, wreck sites and registered parks and gardens in England deemed to be 'at risk'. The 2013 Heritage at Risk Register³² highlighted that there are no features or areas deemed to be at risk in the Neighbourhood Area.
- 4.4.9 It should be noted that not all of the area's historic environment resource is subject to statutory designations, and non-designated features comprise a large part of what people have contact with as part of daily life – whether at home, work or leisure. For example, although not listed, many buildings and areas are of historic interest, and which are seen as important by local communities. Examples of these in the plan area are likely to include parks and the wider historic landscape. Undesignated actual or potential archaeological finds in the area are also of significance.

³⁰ Basingstoke and Deane Borough Council (2003) Conservation Area Appraisal, Overton
<http://www.basingstoke.gov.uk/NR/rdonlyres/1DD295F1-BBC0-4DDE-8818-74802EE13CAB/0/Overton.pdf>

³¹ English Heritage (2004) Extensive Urban Survey - Hampshire and the Isle of Wight
http://archaeologydataservice.ac.uk/archives/view/hampshire_eus_2003/downloads.cfm?REDSQUIDARCHIVES_2699_096EB00F-1F77-420B-98A692541C22AE2E&area1=basingstoke&area2=overton

³² Heritage at Risk Register (2013), <http://risk.english-heritage.org.uk/register.aspx> [accessed 10/12/14]

Summary of future baseline

- 4.4.10 New development areas in the Neighbourhood Area have the potential to impact on the fabric and setting of cultural heritage assets. This includes through inappropriate design and layout. It should be noted, however, that existing historic environment designations and Local Plan policies will offer a degree of protection to cultural heritage assets and their settings.
- 4.4.11 New development has the potential to lead to incremental but small changes in landscape and townscape character and quality in and around the plan area. This includes from the loss of landscape features and visual impact. There are also likely to be potential effects on landscape/townscape character and quality in the vicinity of the road network due to an incremental growth in traffic flows.
- 4.4.12 There are likely to be small scale and incremental changes in tranquillity in and around the plan area, affected by changes in the levels of light and noise pollution.

4.5 Land, soil and water resources

Summary of current baseline

- 4.5.1 The Agricultural Land Classification classifies land into five grades (plus 'non-agricultural' and 'urban'), where Grades 1 to 3a are the 'best and most versatile' land and Grades 3b to 5 are of poorer quality. In terms of the location of the best and most versatile agricultural land in the plan area, land classified as Grade 3a agricultural land is located around Overton village. There are also areas classified as Grade 2 agricultural land to the west and north east of the village. Whilst agricultural land quality the rest of the plan area has not recently been assessed, the Provisional Agricultural Land Classification established it as Grade 3 land³³.
- 4.5.2 There is no Household Waste and Recycling Centre in the plan area. The nearest is located in Basingstoke off Wade Road.
- 4.5.3 The main watercourse in the parish is the River Test. The river flows westwards from its source near the village of Ashe, passing south of Quidhampton, through Overton village and north of Southington. Water supply in the area and waste water provision is provided by Southern Water. The Test and Itchen Catchment Abstraction Management Strategy highlights that there is 'Restricted Water Available for Licensing' in the area. This indicates that if all licensed water is abstracted there will not be enough water left for the needs of the environment.
- 4.5.4 Groundwater Source Protection Zones (SPZs) have been defined by the Environment Agency in England and Wales to protect groundwater sources such as wells, boreholes and springs that are used for public drinking water supply. The zones show the risk of contamination from activities that might cause groundwater pollution in the area. Reflecting the vulnerability of groundwater in the area to pollution, a SPZ underlays much of the southern part of the Neighbourhood Area south of Overton. A further SPZ extends east from the centre of Overton village to Ashe and beyond.
- 4.5.5 The Nitrates Directive (91/676/EEC) requires Member States to identify areas where groundwaters have nitrate concentrations of more than 50 mg/l nitrate or are thought to be at risk of nitrate contamination. Areas associated with such groundwaters are designated as Nitrate Vulnerable Zones (NVZs) within which, Member States are required to establish Action Programmes in order to reduce and prevent further nitrate contamination. In this context the whole of the plan area is underlain by a eutrophic and groundwater NVZ.

³³ It should be noted that much of the data is from prior to 1976 when the distinction between Grades 3a and 3b was introduced. The maps are intended for strategic use and Natural England state *'these maps are not sufficiently accurate for use in assessment of individual fields', or sites and any enlargement could be misleading*". A soil survey should be undertaken to verify the actual classification 'on the ground' – see <http://publications.naturalengland.org.uk/publication/141047?category=2595819>

Summary of future baseline

- 4.5.6 A higher proportion of development has the potential to take place on greenfield land. This is especially the case given the greater availability of such land in the plan area and the likely growth in the local population and economy which will make such development attractive. Development in the plan area also has the potential to lead to the loss of some areas of the best and most versatile agricultural land, including Grade 2 and 3a agricultural land.
- 4.5.7 Due to increasing legislative and regulatory requirements, there are increasing pressures to improve recycling and composting rates.
- 4.5.8 In terms of water quality, the requirements of the Water Framework Directive are likely to lead to continued improvements to water quality in watercourses in the wider area. Water quality is also likely to continue to be affected by pollution incidents in the area, the presence of non-native species and physical modifications to water bodies.
- 4.5.9 Water availability in the wider area may be affected by regional increases in population and an increased occurrence of drought exacerbated by the effects of climate change.

4.6 Population and community

Summary of current baseline

- 4.6.1 According to the most recent census data available, in 2011 the total population of the parish of Overton was 4,315³⁴. This was an increase of 367 from the 2001 census, or a 9.3% population growth (see Table 4.1). The rate of growth in Overton parish is significantly higher than regional and national comparators, and slightly lower than the borough growth rate.

Table 4.1 Population growth, 2001-2011³⁵

Date	Overton	Basingstoke & Deane	South East	England
Population Change 2001 to 2011	9.3%	9.98%	7.93%	7.88%

- 4.6.2 The Neighbourhood Area has a significantly lower proportion of individuals across the 0-44 age range than all other comparators. There is a higher proportion of the 45-59 age group within the plan area than national and borough averages, and a significantly higher proportion of residents aged 60 and over when compared to Basingstoke and Deane, the South-East and England. There are 1,284 people aged 60 or over living in the plan area, which is 29.8% of the population.
- 4.6.3 Census statistics which measure deprivation across the four 'dimensions' of deprivation³⁶ including: any member of a household not a full-time student is either unemployed or long-term sick; education (no person in the household has at least level 2 education, and no person aged 16-18 is a full-time student); health and disability (any person in the household has general health 'bad or 'very bad' or has a long term health problem); and housing (household's accommodation is either overcrowded,

³⁴ Office for National Statistics (2011) Neighbourhood Statistics [online] available at: <http://www.neighbourhood.statistics.gov.uk/dissemination/>

³⁵ ONS (2011) Census 2011, Population Density, 2001 (UV02)

³⁶ ONS (2011) Census 2011, Households by Deprivation Dimensions, 2011 (QS119EW)

with an occupancy rating -1 or less, or is in a shared dwelling, or has no central heating), show that the parish of Overton has deprivation levels that are largely in line with the borough of Basingstoke and Deane (see Figure 4.1), with lower levels of deprivation in 2 and 3 dimensions than the regional and national averages.

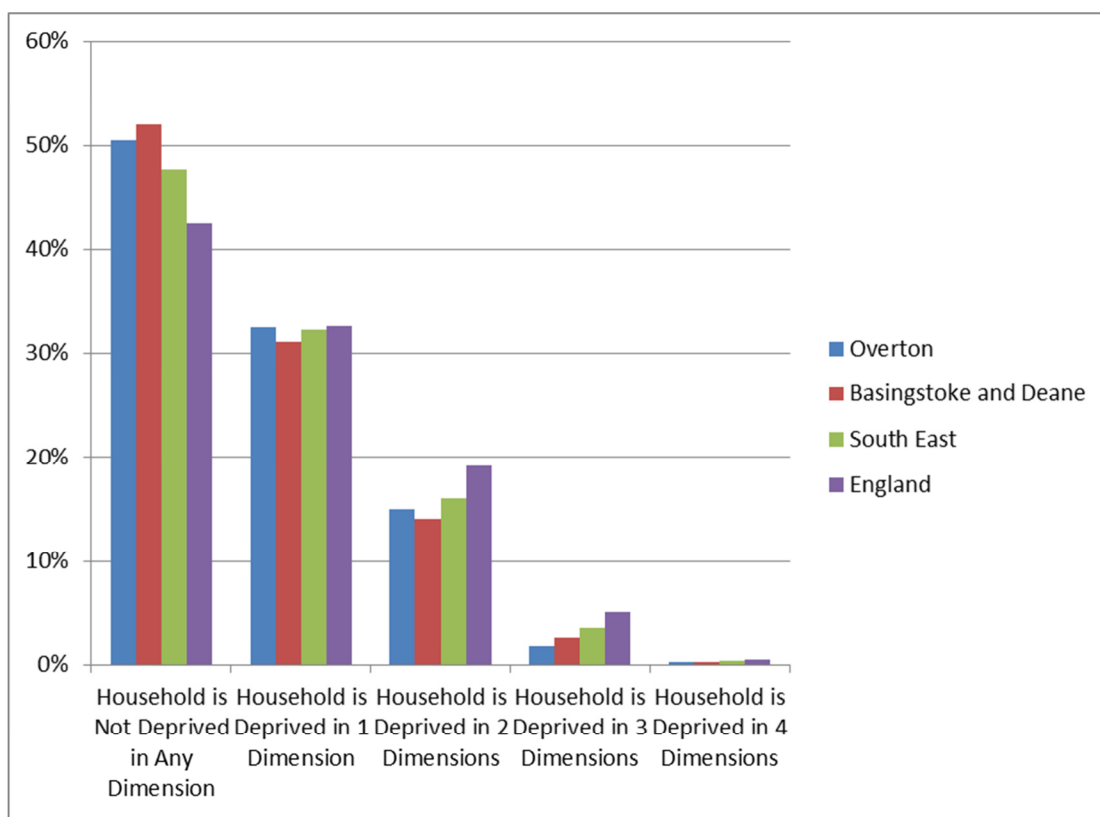

Figure 4.1 Relative deprivation dimensions

- 4.6.4 A higher proportion of Overton residents live in housing owned either outright or with a mortgage (69.4% in total), than borough (67.7%), regional (67.6%) or national (63.3%) averages. Conversely Overton has a significantly lower proportion of people that rent (10.3%) than tenure values at borough and national level. The plan area has similar proportions of social rented tenures as borough and national averages, which are significantly higher than the regional level.
- 4.6.5 In 2013 there were 6,673 households on local authority housing waiting lists in Basingstoke and Deane, an increase of 595 since 2010.³⁷ There has been a decrease of 409 households on local authority housing waiting lists in Hampshire as a whole from 2010 to 2013.
- 4.6.6 The population of the plan area is generally well qualified, with 33.8% of residents aged 16 and above having at least a Level 4 Qualification³⁸. This is significantly higher than the borough level (30.5%), regional (29.9%) and national (27.4%) averages³⁹. Conversely, more people have no qualifications (21.1%) than borough (17.3%) and regional (19.1%) averages. This remains however significantly lower than national values (22.5%).

Summary of future baseline

- 4.6.7 The population of the Neighbourhood Area is likely to continue to grow and age.

³⁷ DCLG (2012) Statistical data set Live tables on rents, lettings and tenancies. Table 600: numbers of households on local authorities' housing waiting lists, by district: England 1997 to 2013.

³⁸ Level 4 and above qualifications cover: Degree (BA, BSc), Higher Degree (MA, PhD, PGCE), NVQ Level 4-5, HNC, HND, RSA Higher Diploma, BTEC Higher Level, Professional Qualifications (Teaching, Nursing, Accountancy).

³⁹ ONS (2011) Census 2011, Qualifications and Students (KS501EW)

- 4.6.8 The suitability (e.g. size and design) and affordability of housing for local requirements depends on the implementation of appropriate housing policies through the Local Plan and Neighbourhood Plan. Unplanned development may have wider implications in terms of transport and access to infrastructure, or the natural environment.
- 4.6.9 The adult population across the plan area is largely well educated, with a significant number of people with degree level qualifications resident above the borough, regional and national average. Increasing economic activity rates are likely to increase demand for new housing and employment opportunities in the area.

4.7 Health and wellbeing

Summary of current baseline

- 4.7.1 As highlighted in Table 9.1, general health across the parish is broadly favourable compared to regional and national averages, and slightly less favourable than Basingstoke and Deane averages. In this context 50% of people reported that they were in 'very good' health⁴⁰, which is slightly below borough values, and above regional and national averages. Likewise the proportion of people in 'very bad health' is slightly higher than borough averages, and lower than regional and national averages.

Table 4.2 General Health

	Overton	Basingstoke and Deane	South East	England
Good Health	34.1%	35.1%	34.6%	34.2%
Bad Health	2.8%	2.7%	3.4%	4.2%

- 4.7.2 6.2% of residents of Overton parish reported that they were limited 'a lot' with day to day activities due to long-term health problems or disabilities, with 9.6% of people limited 'a little'. The levels of long term health and disability⁴¹ in Overton are broadly in line with borough, regional and national averages.
- 4.7.3 No data exists for the plan area for life expectancy and health indicators; however at the borough level the 2013 Health Profile⁴² shows that life expectancy in Basingstoke and Deane is 80.8 for men and 83.0 for women; above the national average of 73.8 and 79.3, respectively. Life expectancy is 6.7 years lower for men and 4.7 years lower for women in the most deprived areas of Basingstoke and Deane than in the least deprived areas. Local priorities in Basingstoke and Deane include lifestyle risks, healthy ageing, and mental health.

Summary of future baseline

- 4.7.4 The population of the plan area is predicted to grow and age in the future. This will place pressure on existing health and community facilities that are likely to face greater demand from residents.

⁴⁰ ONS (2011) Census 2011, General Health (QS302EW)

⁴¹ ONS (2011) Census 2011, Long-Term Health Problem or Disability, 2011 (QS303EW)

⁴² Public Health England (2013) Health Profile 2013 [online] available at: <http://www.apho.org.uk/resource/view.aspx?RID=50215&SEARCH=basingstoke%20and%20deane&SPEAR=> (accessed 6/11/2014)

- 4.7.5 Obesity is on the increase and of increasing concern to health professionals, and one that will contribute to significant health impacts on individuals, including increasing the risk of a range of diseases, including heart disease, diabetes and some forms of cancer.

4.8 Transportation

Summary of current baseline

Rail network

- 4.8.1 The Neighbourhood Area is well connected by rail. The parish is served by Overton railway station (in Quidhampton immediately north of Overton village) and Micheldever station (which is located just south of parish boundaries c.6.5km from Overton village). Basingstoke station, which has a wider range of rail services, is located c.13km from Overton village.
- 4.8.2 Overton station is located on the London Waterloo to Salisbury / Exeter line with direct services to London Waterloo (approximately 1 hour), Andover (13 minutes), Woking (29 minutes), and Salisbury (33 minutes).
- 4.8.3 Micheldever station is located on the main London Waterloo to Southampton / Bournemouth / Weymouth line. However, most direct services from the station comprise part of the London Waterloo to Portsmouth Harbour service via Fareham. Direct services from Micheldever include Winchester (8 minutes), Woking (38 minutes), London Waterloo (65 minutes) and Portsmouth Harbour (70 minutes).
- 4.8.4 Basingstoke station is located on the main London Waterloo to Southampton / Bournemouth / Weymouth line, the London Waterloo to Salisbury / Exeter line and the Cross Country Trains line to Oxford, Birmingham and the north of England. Direct services include to Winchester (15 minutes), Reading (16 minutes), Andover (16 minutes), Woking (18 minutes), Southampton (33 minutes), Salisbury (35 minutes), Oxford (46 minutes), London Waterloo (46 minutes), Bournemouth (1 hour) and Birmingham (c.2hrs).

Bus network

- 4.8.5 Overton is connected by bus to Basingstoke and Oakley, Whitchurch, Andover and Winchester via Stagecoach services number 76 and 86. Journey times to Basingstoke are approximately 25 minutes from Overton, approximately every half hour. On Sundays the 76 bus passes through Overton on an hourly basis. Service number 74 connects areas within the village not served by Stagecoach.

Road network

- 4.8.6 The main route through the Neighbourhood Area is the B3400, which connects the plan area with Oakley and Basingstoke to the east and Whitchurch and the A34 to the west. The B3051 connects the Neighbourhood Area to the A339 in the north and to the A303 at the southern boundary of the parish. The route locally known as the C29 connects the plan area to the A303.

Availability of cars and vans

- 4.8.7 The proportion of car or van ownership in Overton is largely in line with the borough average, in that the proportion of households with no access to a car/van is significantly lower than regional and national averages, whilst the proportion of the population with two or more cars/vans is significantly higher. The proportion of households with three or more vehicles is higher than all comparators. High car ownership in the Neighbourhood Area reflects the relative affluence of the plan area and its rural nature.

Travel to work

- 4.8.8 The proportion of people in Overton who travel to work on foot or bicycle is lower than borough, regional or national averages. Similarly the proportion of people who travel by bus/minibus/coach or as a passenger in a car or van in Overton is lower than all comparators. A higher proportion of people travel to work by car or van than regional or national averages. This proportion is however marginally lower than the borough average.
- 4.8.9 In Overton, a higher proportion of people travel by train to work than borough, regional and national comparators.

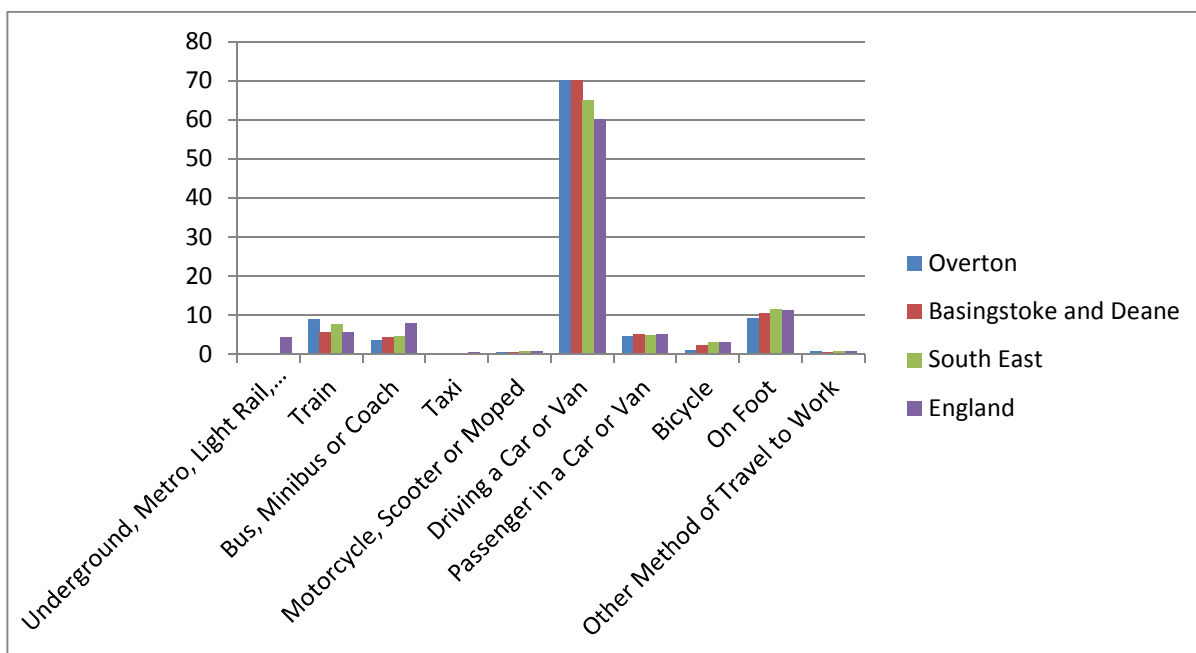
Figure 4.3: Method of Travel to Work⁴³Summary of future baseline

- 4.8.10 An increase in the Neighbourhood Area's population has the potential to lead to increased traffic and congestion. This has the potential to be at least in part mitigated by measures outlined in the Local Plan and the Hampshire Local Transport Plan.
- 4.8.11 The viability of additional bus services may be supported by future population growth. This may also apply to rail services; however peak time rail services are currently at capacity.

4.9 Economy and enterpriseSummary of current baseline

- 4.9.1 Economic activity rates in the plan area are broadly in line with regional averages, but lower than borough values.
- 4.9.2 Rates of full-time employment in Overton (44.5%) are lower than across Basingstoke and Deane (47.9%) but are significantly higher than regional (40.5%) and national (38.6%) rates. Rates of part-time employment in Overton are significantly lower than comparators.⁴⁴
- 4.9.3 Rates of self-employment (with employees) are broadly in line with borough, regional and national level, with a higher percentage of part time sole traders (3.7%) and a lower percentage of full time

⁴³ ONS (2011) Census 2011, Method of Travel to Work (QS701EW)⁴⁴ ONS (2011) Census 2011, Economic Activity (QS601EW)

sole traders (4.9%) in the Neighbourhood Area than other comparable areas. The proportion of residents who are unemployed is largely in line with borough and regional averages, but below the national average. The proportion of people retired (18.2%) in the plan area is significantly higher than borough (12.6%), regional (13.7%) and national (13.7%) averages.

- 4.9.4 The plan area has a highly qualified population compared to borough, regional and national averages, with 33.8% of working-age residents of the plan area qualified to NVQ level four or above.⁴⁵ There is however a higher proportion of residents in Overton parish (21.1%) that have no qualifications, when compared with borough (17.3%) and regional (19.1%) averages. This is slightly below the national average (22.5%).
- 4.9.5 Figure 4.4 shows the occupation of working-age residents. Overall, the occupation profile for Overton is largely similar to borough, regional and national averages, with some notable exceptions. The plan area has larger proportions of people working in 'manufacturing', 'information and communications', and 'professional, scientific and technical activities'. Conversely, the plan area has lower proportions of workers in 'arts, entertainment and recreation', 'accommodation and food service activities', 'wholesale and retail trade; repair of motor vehicles and motor cycles', and 'construction'.

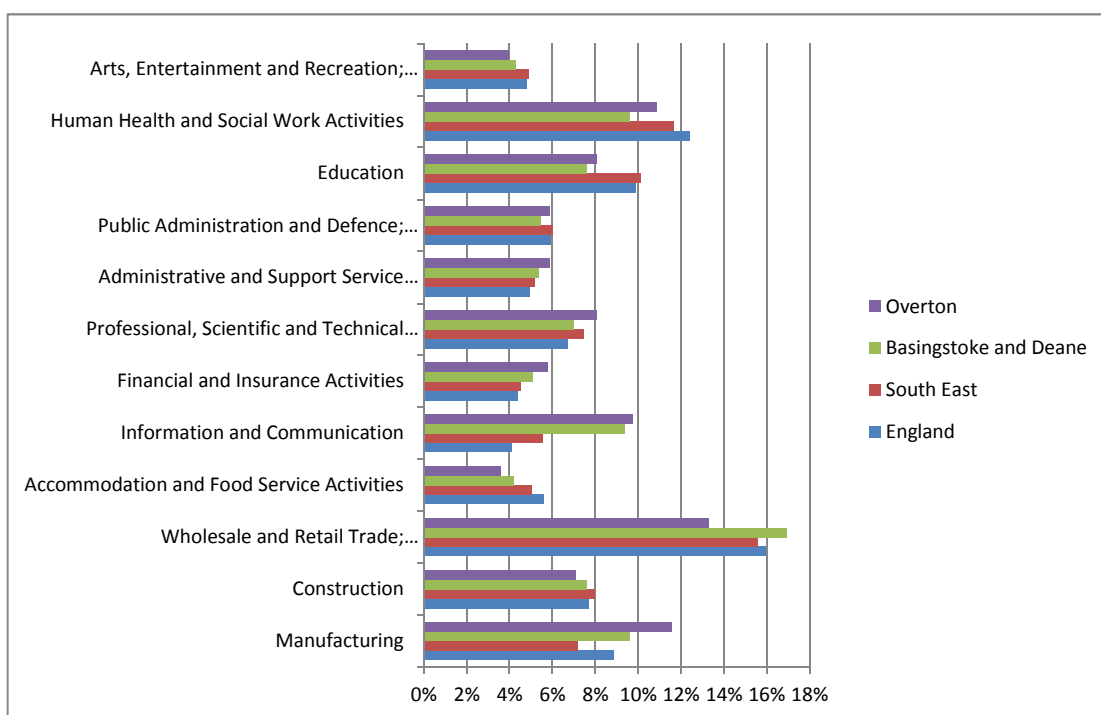

Figure 4.4 The industry of usual residents aged 16 to 74 in employment in the week of working-age residents⁴⁶

Summary of future baseline

- 4.9.6 There will be an increased demand for services and facilities in the plan area with population growth. Increased economic activity in Basingstoke may provide economic opportunities for those living in the Neighbourhood Area.

⁴⁵ Level 4 qualifications include bachelors degrees, NVQs at Level 4, HNDs and HNCs.

⁴⁶ ONS (2011) Industry 2011 (QS605EW)

5 What are the key issues and objectives that should be a focus?

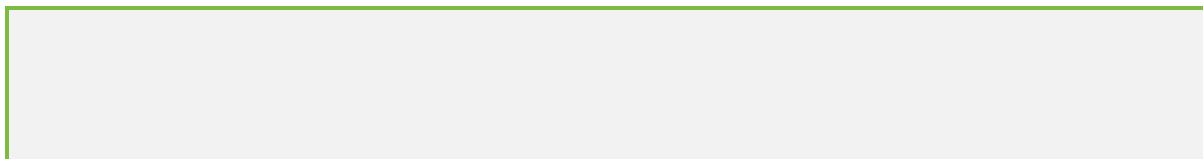

5.1 Introduction

5.1.1 Drawing on the review of the sustainability context and baseline, the SA Scoping Report (December 2014) was able to identify a range of sustainability problems / issues that should be a particular focus of SA, ensuring it remains focused. These issues were then translated into sustainability 'objectives'. These SA Objectives provide a methodological framework for the appraisal of likely significant effects on the baseline.

5.2 Sustainability topics and objectives

SA Topic	SA Objectives
Biodiversity	Protect and enhance all biodiversity and geological features
Climate change	Promote climate change mitigation in Overton
	Support the resilience of Overton to the potential effects of climate change
Historic environment and landscape	Protect, maintain and enhance Overton's cultural heritage resource, including its historic environment and archaeological assets.
	Protect and enhance the character and quality of landscapes and townscapes.
Land, soil and water resources	Ensure the more efficient use of land.
	Promote sustainable waste management solutions that encourage the reduction, re-use and recycling of waste.
	Use and manage water resources in a sustainable manner.
Population and community	Cater for existing and future residents' needs as well as the needs of different groups in the community, and improve equality of access to local, high-quality community services and facilities.
	Reduce poverty and deprivation and promote more inclusive and self-contained communities.
	Provide everyone with the opportunity to live in good quality, affordable housing, and ensure an appropriate mix of dwelling sizes, types and tenures.
Health and wellbeing	Improve the health and well-being of Overton's residents.
Transportation	Promote sustainable transport use and reduce the need to travel.
Economy and enterprise	Enhance the vitality and viability of the Neighbourhood Area

- 5.2.1 The full SA Framework of objectives and decision-making questions developed during the scoping stage of the SA and against which the plan has been appraised are presented in **Appendix II**.

Part 2: What has plan making / SA involved to this point?

6 Introduction to Part 2

The SA Report must include...

- An outline of the reasons for selecting the alternatives dealt with
- The likely significant effects on the environment associated with alternatives / an outline of the reasons for selecting the preferred approach in-light of alternatives appraisal (and hence, by proxy, a description of how environmental objectives and considerations are reflected in the draft plan)

The 'narrative' of plan-making / SA up to this point is told within this part of the SA Report. Specifically, this section explains how preparation of the current Submission version of the Overton Neighbourhood Plan has been informed by an appraisal of a number of alternative approaches to delivering the Local Plan allocation for housing in the Neighbourhood Area.

6.1 Overview of plan-making / SA work undertaken since 2013

- 6.1.1 Plan-making for the ONP has been underway since late 2013. Initial work incorporated an extensive number of informal and formal consultation exercises carried out by the Neighbourhood Plan Steering Group, including consultation events, resident surveys, and engagement with local organisations. This was accompanied by the collation of baseline information from existing surveys and studies.
- 6.1.2 Initial public consultation on the Neighbourhood Plan was undertaken between May and July 2014. An article was published on the Neighbourhood Plan, and a number of consultation events carried out. Drawing on the findings of these events, a questionnaire was then prepared, which sought residents' views on the likely content of the Neighbourhood Plan.
- 6.1.3 Following these preliminary consultation exercises, the Vision and Objectives for the ONP were developed. A number of housing delivery site options were also considered for potential inclusion in the plan. Subsequently, in November 2014, the Steering Group released a preliminary Neighbourhood Plan document for consultation. This included the Vision and Objectives for the ONP, and a series of proposed 'strategic options' for housing and proposed site selection criteria. The document was sent to every household in the parish and two exhibitions undertaken.
- 6.1.4 In late January 2015, a further public exhibition was undertaken, which presented revised strategic options for housing sites and developers' proposals. Summary findings of the SA process undertaken to date (section 6.2) were also presented.
- 6.1.5 The site allocations and policies for the Neighbourhood Plan were then further worked up in the period to February 2015 and presented in the Regulation 14 consultation version of the Neighbourhood Plan. The Regulation 14 consultation of the Overton Neighbourhood Plan was then released for consultation (accompanied by an SA Report) for a period of six weeks' consultation between 16th February 2015 and 31st March 2015. In April and May 2015 the Neighbourhood Plan was then further updated to reflect responses received during Regulation 14 consultation.
- 6.1.6 The following chapter discusses in more detail the evolution of sites and policies for the ONP in association with the SA process.

6.2 Appraisal of reasonable alternatives for the Neighbourhood Plan

Reasonable alternatives

6.2.1 A key element of the SA process is the appraisal of 'reasonable alternatives' for the ONP. In this context a number of reasonable alternatives have been considered in relation to the scale and location of housing allocations put forward by the ONP for the Neighbourhood Area. These allocations are designed to deliver the housing numbers set out by the emerging Basingstoke and Deane Local Plan.

Appraisal of single vs multiple housing sites to deliver the Local Plan allocation for Overton

6.2.2 Undertaken as a central element of the development of the latest version of the Neighbourhood Plan, the ONP Steering Group considered what size and form new housing sites should take during the life of the plan.

6.2.3 To support decision-making on this element of the ONP, the SA process considered two broad options relating to the number of housing allocations taken forward to deliver the housing numbers set out for the Overton area by the emerging Basingstoke and Deane Local Plan.

6.2.4 The two options, which were consulted on through the consultation undertaken between 21st May and 31st July, 2014, were as follows:

- **Option 1:** Delivery of the emerging Basingstoke and Deane Local Plan's housing allocation for the Overton area through one site; and
- **Option 2:** Delivery of the emerging Basingstoke and Deane Local Plan's housing allocation for the Overton area through multiple sites.

6.2.5 These options were considered through the SA Framework of objectives and appraisal questions developed during scoping (see **Part 1**).

6.2.6 **Table 6.1** presents the findings of the appraisal of Option 1 and Option 2 outlined above. These are presented through the eight sustainability topics discussed in section 2.1.3. To support the appraisal findings, the two options have been ranked in terms of their sustainability performance against the relevant topic. It is anticipated that this will provide the reader with a likely indication of the comparative sustainability performance of the two options in relation to each topic.

Table 6.1 Appraisal findings: reasonable alternatives linked to the number of housing sites

Option 1: Delivery of the emerging Basingstoke and Deane Local Plan s housing allocation for the Overton area through one site			
Option 2: Delivery of the emerging Basingstoke and Deane Local Plan s housing allocation for the Overton area through multiple sites			
SA topic	Discussion of potential effects and relative merits of options	Rank of preference	
		Opt 1	Opt 2
Biodiversity	<p>Option 1, through delivering housing allocations on one larger site has the potential to lead to an increased magnitude of localised effects on individual biodiversity assets. This includes through habitat loss and direct and indirect impacts on species. Option 2 may however lead to increases in incremental effects on biodiversity through smaller scale but multiple impacts on assets.</p> <p>All sites have the potential to have impacts on biodiversity assets if located inappropriately and have poor design and layout. Likewise all sites have the potential to promote net gains in biodiversity value. In this context, for all sites, potential effects on biodiversity depend on elements such as the provision of green infrastructure to accompany new development areas and the retention and incorporation of biodiversity features.</p>	2=	2=
Climate change	<p>In terms of greenhouse gas emissions, road transport is an increasingly significant contributor to emissions in the plan area. The extent to which the two options have the potential to support climate change mitigation through facilitating a reduced level of car dependency is therefore a key element. In this context, Option 2, through promoting housing provision in smaller sites across the plan area, has increased potential to facilitate the development of new housing at locations which are more integrated with the existing built up area of Overton. This has the potential to allow at some locations easier access to services and facilities by sustainable modes of transport such as walking and cycling (this however depends on the location of sites- for example a number of the available sites likely to be considered under this option are at some distance from public transport routes and the village centre). However Option 1, through promoting a larger scale site, may enable more effective improvements to walking and cycling and public transport links through the infrastructure opportunities afforded by larger allocations.</p> <p>In terms of climate change adaptation, enhancements to the plan area's green infrastructure networks will be a key means of helping the plan area adapt to the effects of climate change. This includes through helping to regulate extreme temperatures and regulate surface water run-off. Whilst the direct provision of green infrastructure improvements to accompany new development areas may be more tangible through the larger development proposed through Option 1, mechanisms including the community infrastructure levy provide opportunities for plan area-wide green infrastructure improvements through both options.</p> <p>The effect of new development areas on surface water and groundwater flooding depends on their location and the implementation of sustainable urban drainage systems.</p>	2=	2=

Option 1: Delivery of the emerging Basingstoke and Deane Local Plan s housing allocation for the Overton area through one site			
Option 2: Delivery of the emerging Basingstoke and Deane Local Plan s housing allocation for the Overton area through multiple sites			
SA topic	Discussion of potential effects and relative merits of options	Rank of preference	
		Opt 1	Opt 2
Land, soil and water resources	<p>Option 2, through spreading development across multiple sites, has the potential to limit development on the areas of the best and most versatile agricultural land (including Grade 2 and 3a land) which are present in the vicinity of Overton. This includes the Grade 2 land present to the west and north east of the village. This however depends on the location of development sites and the extent to which lower quality agricultural land is prioritised.</p> <p>In terms of water quality, it is difficult to come to a conclusion regarding the potential for development at any given location to result in negative effects without an understanding of the design measures that will be put in place. For example sustainable drainage systems – SuDS – are an effective means of minimising surface water runoff and hence pollution. However it should be noted that there is likely to be more scope for the implementation of measures such as SuDS within the larger developments promoted by Option 1.</p>	2	1
Historic environment and landscape	<p>Through concentrating new housing provision on one large site, Option 1 has increased potential to lead to impacts on landscape quality. This includes through loss of landscape features, visual impacts and impacts on noise quality linked to increased traffic flows. Whilst major new development areas are unlikely to be located within the North Wessex Downs AONB, views from the AONB may be adversely affected by larger sites.</p> <p>Meeting housing provision through an increased number of smaller sites is less likely to have impacts on landscape quality in the plan area. This is due to increased opportunities through this option for assimilating new development within the existing fabric of the built-up area of Overton. The option also increases opportunities for managing the cumulative landscape impacts of the housing provision for the plan area stipulated by the Local Plan.</p> <p>In terms of potential effects on the historic environment, Option 1, through promoting larger scale housing development in the Overton area, has the potential to have significant effects on the existing historic setting of the village. Through promoting more compact housing development sites, Option 2 is more likely to facilitate housing provision which more effectively sits within the historic setting of the settlement.</p>	2	1

Option 1: Delivery of the emerging Basingstoke and Deane Local Plan s housing allocation for the Overton area through one site			
Option 2: Delivery of the emerging Basingstoke and Deane Local Plan s housing allocation for the Overton area through multiple sites			
SA topic	Discussion of potential effects and relative merits of options	Rank of preference	
		Opt 1	Opt 2
Population and community	<p>Both options will deliver the housing numbers set out for the plan area proposed by the Basingstoke and Deane Local Plan.</p> <p>In terms of affordable housing, such provision may be easier to deliver through Option 1. This is linked to the delivery of Section 106 agreements likely to be levied on the larger development area promoted through this option. Whilst all new developments involving 1 or more dwellings are liable for the community infrastructure levy, concentrating the delivery of housing at fewer and larger sites may help enable the securing of additional contributions to site specific mitigation through Section 106 planning agreements. It should be noted however that such contributions are typically required to make a development proposal acceptable in planning terms that would not otherwise be acceptable. Alongside, recent legislation has introduced a 10 unit threshold for affordable housing contributions.</p> <p>In terms of education and skills, the effect of both options depends on the extent to which new housing provision is accompanied by new, expanded and improved education provision in the Neighbourhood Area.</p>	2=	2=
Health and wellbeing	<p>The delivery of housing provision through one larger site has the potential to concentrate effects on road safety and noise quality from increased traffic flows at certain locations. This may have effects on the health and wellbeing of residents at these locations. However, the cumulative effects of multiple development areas through Option 2 may also have similar effects. Effects therefore depend on the location of new development areas.</p>	2=	2=
Transport	<p>The provision of new and improved sustainable transport infrastructure to accompany new housing development, including pedestrian/cycle and public transport links may be more feasible with the concentrated nature of development proposed through Option 1.</p>	1	2
Economy and enterprise	<p>Through delivering in the region of 150 dwellings in the vicinity of Overton, both options are likely to support the economic vitality and viability of the village.</p>	2=	2=

Appraisal of sites for taking forward through the ONP

- 6.2.7 Following consultation on these two options in summer 2014, an overwhelming majority of residents preferred development on a number of sites rather than a single development. This was confirmed at the consultations in November 2014. The ONP Group therefore took an approach which spread development over a number of sites.
- 6.2.8 In parallel with this process, landowners were invited to propose sites for taking forward for consideration for the purposes of the Neighbourhood Plan. 34 potential sites were initially considered. These were reduced to eleven sites on the basis of the following:
- The landowner could not be identified or had decided not to take forward to site;
 - Part of the site was located on the flood plain;
 - There were restrictive covenants which would be difficult to remove;
 - The landowner had placed restrictions on site use casting doubt on whether the houses could be delivered; and/or
 - The developer did not wish to work within the neighbourhood planning process and proposed to make a planning application ahead of the Overton Neighbourhood Plan.
- 6.2.9 On this basis, the sites considered for the purposes of the Neighbourhood Plan are presented in **Table 6.2** below. The locations of these sites, in conjunction with the environmental constraints present in the area, are presented in the map below⁴⁷. Site D, Great North Field is also shown on the map.

Table 6.2 Sites subsequently considered for the purposes of the Neighbourhood Plan

Site code	Site
A	NW of Primary School
AW	Ashe Warren
B	E of Court Drove
D	Great North Field
E	E of Overton Hill Car Park
F	S of Two Gate Lane
K	W of Pond Close
M	W of Vinn's Lane
PB	Popham Beacons
WW	Willesley Warren

⁴⁷ Please note, Site PB: Popham Beacons is located at the southern edge of the parish near to Micheldever railway station. The area included in this map does not cover this location.

Contains Ordnance Survey Data © Crown Copyright and database right 2015
 © English Heritage [2015]. Contains Ordnance Survey data
 © Crown copyright and database right, [2015]
 The English Heritage GIS Data contained in this material was obtained in Sept 2014.
 © Natural England material is reproduced with the permission of Natural England 2015.

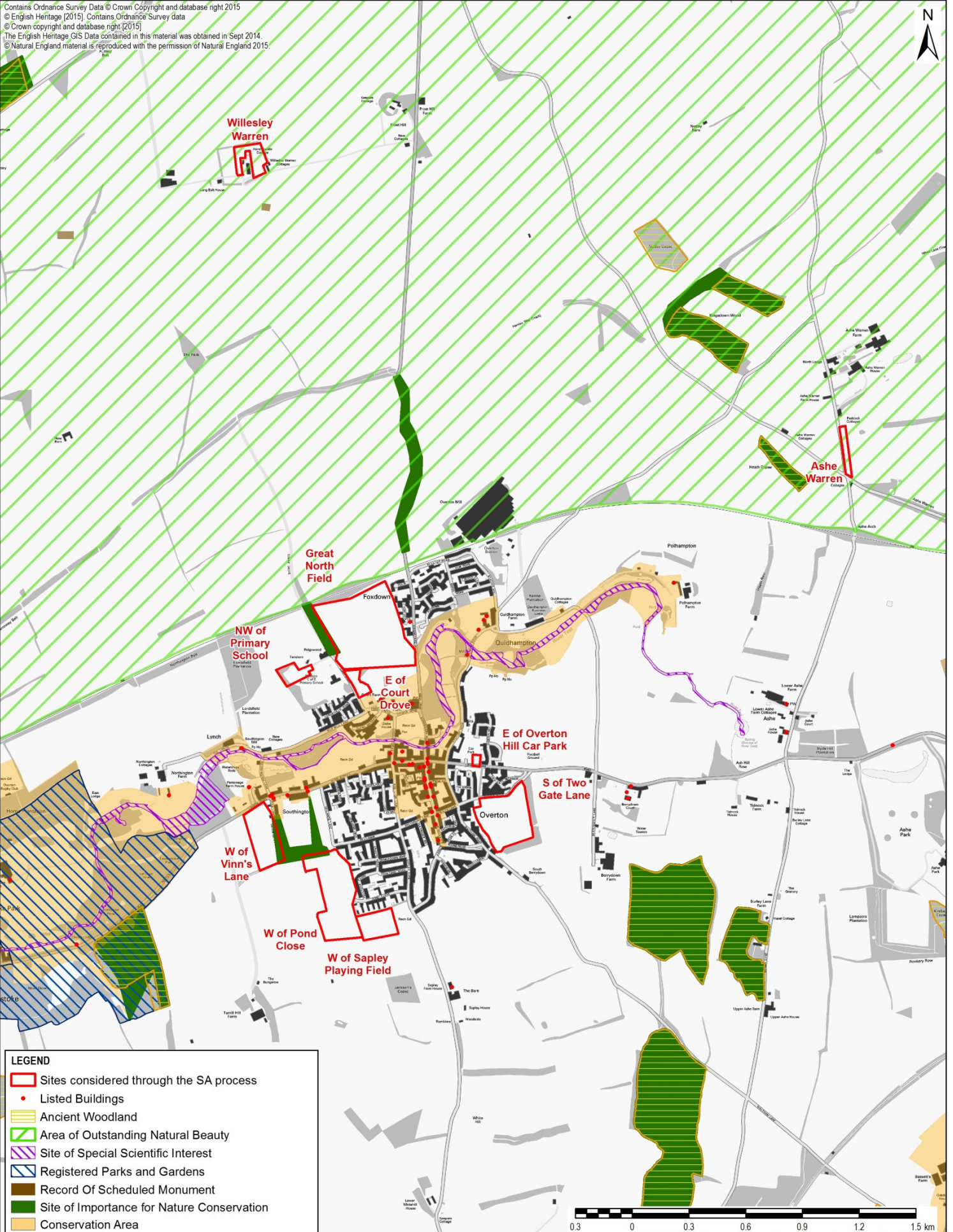

LEGEND	
	Sites considered through the SA process
•	Listed Buildings
	Ancient Woodland
	Area of Outstanding Natural Beauty
	Site of Special Scientific Interest
	Registered Parks and Gardens
	Record Of Scheduled Monument
	Site of Importance for Nature Conservation
	Conservation Area

Project Title/Drawing Title
**SUSTAINABILITY APPRAISAL FOR THE
 OVERTON NEIGHBOURHOOD PLAN:
 ENVIRONMENTAL AND HISTORIC
 CONSTRAINTS**

Client OVERTON PARISH COUNCIL		
Drawn SS	Checked NCB	Approved NCB
Date 03/06/2015	Scale @ A3 1:18,000	Purpose of Issue DRAFT
Drawing Number	Rev 7	

AECOM
 Scott House
 Alençon Link, Basingstoke
 Hampshire, RG21 7PP
 Telephone (01256) 310200
 Fax (01256) 310201
 www.aecom.com







THIS DOCUMENT HAS BEEN PREPARED PURSUANT TO AND SUBJECT TO THE TERMS OF AECOM'S APPOINTMENT BY ITS CLIENT. AECOM ACCEPTS NO LIABILITY FOR ANY USE OF THIS DOCUMENT OTHER THAN BY ITS ORIGINAL CLIENT OR FOLLOWING AECOM'S EXPRESS AGREEMENT TO SUCH USE, AND ONLY FOR THE PURPOSES FOR WHICH IT WAS PREPARED AND PROVIDED.

File Name: Z:\TEMP\Overton Neighbourhood SA\GIS\project_files\MXDs\Overton\Environment\historicConstraints_v7.mxd

- 6.2.10 To support decision making on the choice of sites, the SA team undertook an appraisal of the key constraints present at each of these eleven sites and potential effects that may arise. In this context the sites have been considered in relation to the SA Framework of objectives and decision making questions (Appendix II) developed during SA scoping and the baseline information.
- 6.2.11 The tables below present a summary of this appraisal, and provide an indication of each site's sustainability performance in relation to the eight SA topics.

Biodiversity	Development at the NW of Primary School site would be located adjacent to an area of Deciduous Woodland Biodiversity Action Plan (BAP) Priority Habitat. The site is located in proximity (<200m) to the Court Drove Woodland Strip Site of Importance for Nature Conservation. The site is not within the River Test SSSI Impact Risk Zone for the type and scale of development proposed.	
Climate change	The site is located at relative distance (c.1km) to the services and facilities located in Overton village centre and main bus routes. It is also located approximately 1.3km from the railway station. In relation to adapting to the effects of climate change, according to the Strategic Flood Risk Assessment the site is not located within identified flood risk zones for fluvial or surface water flooding. The site is also located entirely within Flood Zone 1.	
Land, soil and water resources	Development of this site would lead to the loss of 3a agricultural land. This is land classified as the 'Best and Most Versatile' agricultural land. The land has been derelict since 1964. Village-wide, Southern Water has stated that there is limited spare capacity in the sewerage system for new development- however the site is relatively close to the pumping station. In common with all proposed sites, the site is located within a eutrophic and groundwater nitrate vulnerable zone.	
Historic environment and landscape	Whilst the site is located close to the North Wessex Downs AONB, it is located on the southern side of the railway, which will limit effects on views from the AONB. Effects on landscape quality will be further limited by the existing 'enclosed' nature of the site. In this context the high level of physical and visual containment of the site limits potential impacts on the scenic qualities or tranquillity of the AONB. No designated sites, features or areas including listed buildings, conservation areas or scheduled monuments are present close to the site. The site is located 300m north of the Overton Conservation Area.	
Population and community	The site is located at relative distance (c.1km) to the services and facilities located in Overton village centre and main bus routes. It is also located approximately 1.3km from the railway station. This may limit accessibility to services, facilities and employment opportunities without access to the private car. The proximity of Overton Primary School will however promote accessibility to the school.	
Health and wellbeing	No significant effects on health and wellbeing have been identified at this level of detail.	
Transport	The site is located at relative distance (c.1km) to the services and facilities located in Overton village centre and main bus routes. It is also located approximately 1.3km from the railway station.	
Economy and enterprise	The delivery of new housing will support the viability and vitality of the village, including through supporting local shops and amenities and public transport networks.	

Key

Likely adverse effect (without mitigation measures)		Likely positive effect	
Neutral/no effect		Uncertain effects	

SA topic	Commentary, Site AW: Ashe Warren	
Biodiversity	<p>The site is located adjacent to areas of Biodiversity Action Plan Priority Habitat (Deciduous Woodland).</p> <p>The site is not within an SSSI Impact Risk Zone for the type and scale of development proposed.</p>	
Climate change	<p>Road transport is an increasingly significant contributor to emissions in the Overton Neighbourhood Plan Area. Therefore the site's location at some distance from the village (c.4km) and key transport links will increase the need to travel and promote car use for those living at this location.</p> <p>In relation to adapting to the effects of climate change, according to the Strategic Flood Risk Assessment the site is not located within identified flood risk zones for fluvial or surface water flooding. The site is also located entirely within Flood Zone 1.</p>	
Land, soil and water resources	<p>Recent surveys of agricultural land classification have not been carried out for the site. It is therefore uncertain as to whether land at these locations comprises the Best and Most Versatile Agricultural Land.</p> <p>In common with all proposed sites, the site is located within a eutrophic and groundwater nitrate vulnerable zone.</p>	
Historic environment and landscape	<p>The site is located within the North Wessex Downs AONB. Whilst the allocation would likely to be small in scale (comprising c. 5 dwellings), it has the potential to lead to adverse effects on the integrity of the AONB without the implementation of careful design and layout and the integration of appropriate landscaping.</p> <p>According to the Hampshire County Integrated Character Assessment, the site is located within the Hannington and Dummer Downs Character Area. A key characteristic of this area comprises wooded downland between Basingstoke in the East and the Test Valley in the West. It is distinguished from the land around it by its elevation and woodland cover, and the transitional nature of its historic evolution of land use from intensive in the west to extensive in the east. The northern extent of the area (where the site is located) is defined by the change in geology from the chalk to the lower lying clay landscapes. Key 'forces for change' in the area include:</p> <ul style="list-style-type: none"> • Changes in agricultural practice and woodland management, particularly relating to intensification of agriculture. • New development, including future expansion of Basingstoke and (potentially) Overton (all adjacent to this character area) and potential future development of wind turbines and other vertical structures. • Major transport routes, leading to loss of tranquillity and local character • Climate change, particularly potential impacts on farming patterns and tree loss. • Demand for access and recreation, due to proximity of the area to centres of population⁴⁸. <p>In this context, development at this location will lead to changes in the landscape context of the existing hamlet.</p> <p>Whilst the site is not located close to listed buildings, conservation areas or scheduled monuments, four sites locally are recorded on the Hampshire Historic Environment Record.</p>	

⁴⁸ Hampshire County Integrated Character Assessment: Willesley and Litchfield Dipslope Open Downs Character Area
http://www3.hants.gov.uk/7b_hannington_and_dummer_downs.pdf

Population and community	Whilst accessibility to services and facilities is poor from the site, allocations at these locations are designed to provide housing for families engaged in farming locally. This will help meet local housing needs.	
Health and wellbeing	No significant effects on health and wellbeing have been identified at this level of detail.	
Transport	The site is located at significant distance (c.4km) to the services and facilities located in Overton village centre and 1.3km from bus routes. It is also located approximately 3km to the railway station.	
Economy and enterprise	The delivery of new housing will support the viability of agricultural uses in the vicinity of the site.	

Key		
Likely adverse effect (without mitigation measures)		Likely positive effect
Neutral/no effect		Uncertain effects

Biodiversity	The site is located within 100m of the Court Drove Woodland Strip Site of Importance for Nature Conservation. The site is not within the River Test SSSI Impact Risk Zone for the type and scale of development proposed.	
Climate change	The site is located in relatively good proximity to Overton village centre (0.6km). This will promote walking and cycling and public transport use, with the potential to help limit emissions from transport. In relation to adapting to the effects of climate change, according to the Strategic Flood Risk Assessment the site is not located within identified flood risk zones for fluvial or surface water flooding. The site is also located entirely within Flood Zone 1.	
Land, soil and water resources	Land at the site has been classified as Grade 3a agricultural land. This is land classified as the Best and Most Versatile Agricultural Land. Village-wide, Southern Water has stated that there is limited spare capacity in the sewerage system for new development- however the site is close to the pumping station. In common with all proposed sites, the site is located within a eutrophic and groundwater nitrate vulnerable zone.	
Historic environment and landscape	In terms of historic environment assets, the southern part of the site extends into the Overton Conservation Area, and is close to the three listed structures at Court Farm (including the Grade II* listed Court Farmhouse and Grade II listed barn and stable. The site is also located within the area of High Archaeological Interest.	
Population and community	The site is located in relatively good proximity (0.6km) to the village centre and local shopping facilities and services, which are accessible by walking and cycling. It is also accessible to public transport networks (including bus services). This will support access to services, facilities and amenities. The site is in close proximity to the primary school.	
Health and wellbeing	No significant effects on health and wellbeing have been identified at this level of detail.	
Transport	The site is located in relatively good proximity (0.6km) to the village centre, close to local shopping facilities and services, which are accessible by walking and cycling. It is also relatively accessible to public transport networks (including bus services). The railway station is approximately 1.3km on foot.	
Economy and enterprise	The delivery of new housing will support the viability and vitality of the village, including through supporting local shops and amenities and public transport networks.	

Key		
Likely adverse effect (without mitigation measures)		Likely positive effect
Neutral/no effect		Uncertain effects

Biodiversity	No Biodiversity Action Plan Priority Habitats are present in the immediate vicinity of the site and the site is not within the River Test SSSI Impact Risk Zone for the type and scale of development proposed.	
Climate change	The site is located in very good proximity to Overton village centre and main bus routes. This will promote walking and cycling and public transport use, with the potential to help limit emissions from transport. In relation to adapting to the effects of climate change, according to the Strategic Flood Risk Assessment the site is not located within identified flood risk zones for fluvial or surface water flooding. The site is also located entirely within Flood Zone 1.	
Land, soil and water resources	Land at the site has been classified as Grade 3a agricultural land. This is land classified as the Best and Most Versatile Agricultural Land. Village-wide, Southern Water has stated that there is limited spare capacity in the sewerage system for new development. In common with all proposed sites, the site is located within a eutrophic and groundwater nitrate vulnerable zone. The southern tip of the site is within a Source Protection Zone 2.	
Historic environment and landscape	No designated historic environment sites, features or areas including listed buildings or scheduled monuments are located in the immediate vicinity of the site. The site is outside of the conservation area. Due to the size of the site and its location within the existing built up footprint of the village, no significant effects on landscape quality are anticipated.	
Population and community	Located on the main bus route to Oakley, Basingstoke and Whitchurch the site has good access to bus services. The site is located in very good proximity to the village centre and local shopping facilities and services, which are accessible by walking and cycling. This will support access to services, facilities and amenities.	
Health and wellbeing	The site's proximity to village services and amenities will promote healthier modes of travel such as walking and cycling.	
Transport	The site is located in very good proximity to the village centre and local shopping facilities and services, which are easily accessible by walking and cycling. The site is located on the main bus route to Oakley, Basingstoke and Whitchurch. The railway station is approximately 1.4km distant.	
Economy and enterprise	The delivery of new housing will support the viability and vitality of the village, including through supporting local shops and amenities and public transport networks.	

Key		
Likely adverse effect (without mitigation measures)		Likely positive effect
Neutral/no effect		Uncertain effects

Biodiversity	Whilst the site itself is a grass ley of low biodiversity value, the site is bounded by an area of Deciduous Woodland BAP Priority Habitat. It is not within the River Test SSSI Impact Risk Zone for the type and scale of development proposed.	
Climate change	The site is located in relatively good proximity (0.5km) to Overton village centre. This will promote walking and cycling and public transport use, with the potential to help limit emissions from transport. In relation to adapting to the effects of climate change, according to the Strategic Flood Risk Assessment the site is not located within identified flood risk zones for fluvial or surface water flooding. The site is also located entirely within Flood Zone 1. There are no records of historic groundwater flooding on the site.	
Land, soil and water resources	83% of the land at the site has been classified as Grade 3a agricultural land. This is land classified as the Best and Most Versatile Agricultural Land. Southern Water has indicated that there would be insufficient capacity for larger scale development at this location (above 20 dwellings). However additional capacity could come forward as part of new development. In common with all proposed sites, the site is located within a eutrophic and groundwater nitrate vulnerable zone. The northern tip of the site is within a Source Protection Zone 2.	
Historic environment and landscape	No designated historic environment sites, features or areas including listed buildings or scheduled monuments are located in the immediate vicinity of the site. The site is outside of the conservation area. The site is located outside of the AONB. However its edge of village location adjacent to open countryside and the topography rising to the south east corner of the site and its size may lead to effects on views from the south east. The site is however screened by mature hedgerows and trees, particularly the more sensitive south and east side. The <i>Basingstoke and Deane Landscape Capacity Study 2010: Site Options</i> determined the site as having high landscape capacity, with medium/low overall landscape sensitivity and low landscape value.	
Population and community	Located to the south of main bus route to Oakley, Basingstoke and Whitchurch, the site has good access to bus services. The site is located in relatively good proximity (0.5km) to the village centre and local shopping facilities and services, which are accessible by walking and cycling. This will support access to services, facilities and amenities.	
Health and wellbeing	No significant effects on health and wellbeing have been identified at this level of detail.	
Transport	The site is located in relatively good proximity to the village centre (c.0.5km) and local shopping facilities and services, which are accessible by walking and cycling. The site is located south of the main bus route to Oakley, Basingstoke and Whitchurch. The railway station is approximately 1.7km distant.	
Economy and enterprise	The delivery of new housing will support the viability and vitality of the village, including through supporting local shops and amenities and public transport networks.	

Key

Likely adverse effect (without mitigation measures)		Likely positive effect	
Neutral/no effect		Uncertain effects	

Biodiversity	In terms of biodiversity considerations, no BAP Priority Habitats or Sites of Importance for Nature Conservation are located close to the site. The site is not within the River Test SSSI Impact Risk Zone for the type and scale of development proposed.	
Climate change	<p>The site is located at some distance (c.1.1km) to the services and facilities located in Overton village centre and main bus routes. It is also located approximately 2.4km to the railway station. This has the potential to encourage car use, with implications for greenhouse gas emissions from transport. However the number 74 bus service includes Pond Close, which is located approximately 100m from this site and connects with Overton village centre and the railway station. There is also a convenience store approximately 300m away.</p> <p>In relation to adapting to the effects of climate change, according to the Strategic Flood Risk Assessment the site is not located within identified flood risk zones for fluvial or surface water flooding. The site is also located entirely within Flood Zone 1. There are no records of historic groundwater flooding on the site. Southern Water has also indicated that development at this location could be accommodated without a significant increased risk of flooding.</p>	
Land, soil and water resources	The site has been classified as Grade 3 agricultural land. As such it is uncertain whether this comprises an area classified as 'the Best and Most Versatile Agricultural Land' (i.e. Grade 3a land). Southern Water have indicated there is sufficient spare capacity in the sewerage system for new development at this location. In common with all proposed sites, the site is located within a eutrophic and groundwater nitrate vulnerable zone.	
Historic environment and landscape	<p>No designated historic environment sites, features or areas including listed buildings or scheduled monuments are located in the immediate vicinity of the site. The site is outside of the conservation area.</p> <p>The site is located outside of the AONB. Whilst its edge of village location adjacent to open countryside may lead to effects on views from the south, the site is well screened.</p>	
Population and community	The site is located at some distance (c.1.1km) to the services and facilities located in Overton village centre. It is also located approximately 2.4km to the railway station. However the number 74 bus service includes Pond Close, which is located approximately 100m from this site and connects with Overton village centre and the railway station.	
Health and wellbeing	No significant effects on health and wellbeing have been identified at this level of detail.	
Transport	The site is located at some distance (c.1.1km) to the services and facilities located in Overton village centre and poorly served by bus. It is also located approximately 2.4km to the railway station. However the number 74 bus service includes Pond Close, which is located approximately 100m from this site and connects with Overton village centre and the railway station	
Economy and enterprise	The delivery of new housing will support the viability and vitality of the village, including through supporting local shops and amenities and public transport networks.	
Key		
Likely adverse effect (without mitigation measures)		Likely positive effect
Neutral/no effect		Uncertain effects

SA topic	Commentary, Site K: West of Pond Close	
Biodiversity	The north western edge of Site K: West of Pond Close overlaps with the Overton Green Lanes and Sunken Tracks Site of Importance for Nature Conservation. The site is not within the River Test SSSI Impact Risk Zone for the type and scale of development proposed.	
Climate change	<p>The site is located at relative distance (c.1km) to the services and facilities located in Overton village centre and main bus routes. It is also located approximately 2.2km to the railway station. This has the potential to encourage car use, with implications for greenhouse gas emissions from transport. However the number 74 bus service includes Pond Close, which is located approximately 100m from this site and connects with Overton village centre and the railway station. There is also a convenience store approximately 300m away.</p> <p>In relation to adapting to the effects of climate change, according to the Strategic Flood Risk Assessment the site is not located within identified flood risk zones for fluvial or surface water flooding. The site is also located entirely within Flood Zone 1. There are no records of historic groundwater flooding on the site.</p>	
Land, soil and water resources	<p>Land at the site has been classified as Grade 3a agricultural land. This is land classified as the Best and Most Versatile Agricultural Land.</p> <p>Southern Water has indicated that there is sufficient capacity in the sewerage system for new development at this location. In common with all proposed sites, the site is located within a eutrophic and groundwater nitrate vulnerable zone.</p> <p>The site overlies safeguarded minerals resources as identified through Policy 15- <i>Mineral Resources</i> of the Hampshire Minerals and Waste Plan⁴⁹, for clay.</p>	
Historic environment and landscape	<p>No designated historic environment sites, features or areas including listed buildings or scheduled monuments are located in the immediate vicinity of the site and the site is located 0.5km from the conservation area.</p> <p>The site is located outside of the AONB. However its edge of village location adjacent to open countryside may lead to effects on views from the south west. The <i>Basingstoke and Deane Landscape Capacity Study 2010: Site Options</i> determined the site as having medium/high landscape capacity, with medium overall landscape sensitivity and medium/low landscape value.</p>	
Population and community	The site is located at relative distance (c.1km) to the services and facilities located in Overton village centre and poorly served by bus. It is also located approximately 2.2km to the railway station. However the number 74 bus service includes Pond Close, which is located approximately 100m from this site and connects with Overton village centre and the railway station. There is also a convenience store approximately 300m away.	
Health and wellbeing	No significant effects on health and wellbeing have been identified at this level of detail.	
Transport	The site is located at relative distance (c.1km) to the services and facilities located in Overton village centre and poorly served by bus. It is also located approximately 2.2km to the railway station. However the number 74 bus service includes Pond Close, which is located approximately 100m from this site and connects with Overton village centre and the railway station. There is also a convenience store approximately 300m away.	
Economy and enterprise	The delivery of new housing will support the viability and vitality of the village, including through supporting local shops and amenities and public transport networks.	

⁴⁹ Hampshire County Council (October 2013) Hampshire Minerals and Waste Plan
<http://www3.hants.gov.uk/mineralsandwaste/planning-policy-home.htm>

SA topic	Commentary, Site M: W of Vinn s Lane	
Biodiversity	<p>Whilst Site M: <i>W of Vinn's Lane</i> is located close to the River Test SSSI, the site is not located within the Impact Risk Zone for the SSSI due to the scale of development proposed at the site.</p> <p>The site is located adjacent to the Overton Green Lanes and Sunken Track Site of Importance for Nature Conservation (located on the eastern side of the site). The site is located on the opposite side of London Road to an area of Deciduous Woodland BAP Priority Habitat.</p>	
Climate change	<p>The site is located at relative distance (c.1km) to the services and facilities located in Overton village centre. It is also located approximately 2.1km to the railway station.</p> <p>The site has good access to bus services, being located close to the A3400, which is one of the main bus routes in the Neighbourhood Area.</p> <p>In relation to adapting to the effects of climate change, according to the Strategic Flood Risk Assessment the site is not located within identified flood risk zones for fluvial or surface water flooding. The site is also located entirely within Flood Zone 1. There are no records of historic groundwater flooding on the site.</p>	
Land, soil and water resources	<p>The site has been classified as Grade 3 agricultural land. As such it is uncertain whether this comprises an area classified as 'the Best and Most Versatile Agricultural Land' (i.e. Grade 3a land).</p> <p>Village-wide, Southern Water has stated that there is limited spare capacity in the sewerage system for new development. In common with all proposed sites, the site is located within a eutrophic and groundwater nitrate vulnerable zone.</p> <p>The site overlies safeguarded minerals resources as identified through Policy 15- <i>Mineral Resources</i> of the Hampshire Minerals and Waste Plan⁵⁰.</p>	
Historic environment and landscape	<p>Development at this site has the potential to have impacts on the integrity of the historic environment at this location with inappropriate design and layout.</p> <p>In terms of sites and areas designated for their historic environment value. Site M: <i>W of Vinn's Lane</i> is located close to three Grade II listed structures, which are located to the north east of the site (Tithe Cottage, 12 and 14 Southington and the telephone kiosk). The site is also located adjacent to the conservation area boundary. In this context development at this location may affect the setting of the historic environment.</p>	
Population and community	<p>The site is located at relative distance (c.0.9km) to the services and facilities located in Overton village centre. It is also located approximately 2.1km to the railway station. However, the site has good access to bus services, being located close to the A3400, which is one of the main bus routes in the Neighbourhood Area.</p>	
Health and wellbeing	<p>No significant effects on health and wellbeing have been identified at this level of detail.</p>	
Transport	<p>The site is located at relative distance (c.0.9km) to the services and facilities located in Overton village centre. It is also located approximately 2.1km to the railway station. However, the site has good access to bus services, being located close to the A3400, which is one of the main bus routes in the Neighbourhood Area.</p>	
Economy and enterprise	<p>The delivery of new housing will support the viability and vitality of the village, including through supporting local shops and amenities and public transport networks.</p>	

⁵⁰ Hampshire County Council (October 2013) Hampshire Minerals and Waste Plan
<http://www3.hants.gov.uk/mineralsandwaste/planning-policy-home.htm>

Biodiversity	<p>Whilst the site is located close to the Micheldever Spoil Heaps SSSI, it is not within the Impact Risk Zone for the SSSI due to the nature of the SSSI and the scale of development proposed.</p> <p>The site is located close to an area of Deciduous Woodland Biodiversity Action Plan Priority Habitat.</p>	
Climate change	<p>Road transport is an increasingly significant contributor to emissions in the Overton Neighbourhood Plan Area. Therefore the site's distance from key services and facilities will increase the need to travel and promote car use for those living at this location. This may in part however be mitigated by the site's location close to Micheldever Station.</p> <p>In relation to adapting to the effects of climate change, according to the Strategic Flood Risk Assessment the site is not located within identified flood risk zones for fluvial or surface water flooding. The site is also located entirely within Flood Zone 1.</p>	
Land, soil and water resources	<p>Land at the site has been classified as Grade 3a agricultural land. This is land classified as the Best and Most Versatile Agricultural Land.</p> <p>In common with all proposed sites, the site is located within a eutrophic and groundwater nitrate vulnerable zone.</p> <p>The site is within a Source Protection Zone 2.</p>	
Historic environment and landscape	<p>Due to the location of the site in the south of the parish Site PB is unlikely to affect the integrity of the North Wessex Downs AONB.</p> <p>The site is located adjacent to the Popham Beacons round barrow cemetery scheduled monument. Six further sites located in the vicinity of the cemetery are listed on the Hampshire Historic Environment Record.</p>	
Population and community	<p>Located at significant distance (c.7km) from Overton village and North Waltham, accessibility to services and facilities is poor from the site. The site is however located close to Micheldever Station.</p>	
Health and wellbeing	<p>The location of the site away from services and facilities may discourage the use of healthier modes of travel such as walking and cycling.</p>	
Transport	<p>The site is located close to Micheldever Station. The site is located at significant distance (c.7km) to the services and facilities located in Overton village centre and North Waltham, and main bus routes.</p>	
Economy and enterprise	<p>The delivery of new housing will support the viability of agricultural uses in the vicinity of the site.</p>	

Key		
Likely adverse effect (without mitigation measures)		Likely positive effect
Neutral/no effect		Uncertain effects

SA topic	Commentary, Site WW: Willesley Warren	
Biodiversity	<p>The site is located adjacent to areas of Biodiversity Action Plan Priority Habitat (Deciduous Woodland).</p> <p>The site is not within an SSSI Impact Risk Zone for the type and scale of development proposed.</p>	
Climate change	<p>Road transport is an increasingly significant contributor to emissions in the Overton Neighbourhood Plan Area. Therefore the location of the site's location at some distance from the village (4.4km) and key transport links will increase the need to travel and promote car use for those living at this location.</p> <p>In relation to adapting to the effects of climate change, according to the Strategic Flood Risk Assessment the site is not located within identified flood risk zones for fluvial or surface water flooding. The site is also located entirely within Flood Zone 1.</p>	
Land, soil and water resources	<p>Recent surveys of agricultural land classification have not been carried out for the site. It is therefore uncertain as to whether land at these locations comprises the Best and Most Versatile Agricultural Land.</p> <p>In common with all proposed sites, the site is located within a eutrophic and groundwater nitrate vulnerable zone.</p>	
Historic environment and landscape	<p>The site is located within the North Wessex Downs AONB. Whilst the allocation would likely to be small in scale (comprising c. 5 dwellings), it has the potential to lead to adverse effects on the integrity of the AONB without the implementation of careful design and layout and the integration of appropriate landscaping.</p> <p>According to the Hampshire County Integrated Character Assessment, the site is located within the Willesley and Litchfield Dipslope Open Downs Character Area. Key characteristics include: dramatic sweeping chalk downland forming a dip slope with elevation falling in a southerly direction; sense of elevation and openness with uninterrupted views; arable land use predominates with some remnants of chalk grassland which increase the biodiversity of the area; weak pattern of low hedgerows enclose large fields; a palimpsest landscape with significant time depth since the Neolithic; lack of settlement and sparse population- settlements comprises dispersed patterns of occasional large farms; quiet and rural character with a strong sense of openness and space. The highlighted 'forces for change' in the area are:</p> <ul style="list-style-type: none"> • Intensification of agriculture and changes in land management. • Potential demand for masts and other tall structures on skylines. • Incremental suburbanisation of rural lanes, and loss of tranquillity in the vicinity of major roads. • Climate change, particularly affecting crops and agricultural patterns. • Demand for access and recreation, including use by off-road vehicles⁵¹. <p>In this context, development at this location will lead to changes in the landscape context of the existing hamlet.</p> <p>In terms of historic environment constraints, the site is located 250m north east of the long barrow scheduled monument. Three further sites in the vicinity are listed on the Hampshire Historic Environment Record (including the Old Farmhouse).</p>	
Population and community	<p>Whilst accessibility to services and facilities is poor from the site, allocations at these locations are designed to provide housing for families engaged in farming locally. This will help meet local housing needs.</p>	

⁵¹ Hampshire County Integrated Character Assessment: Willesley and Litchfield Dipslope Open Downs Character Area
http://www3.hants.gov.uk/8a_willesley_and_litchfield_dipslope_open_downs.pdf

Health and wellbeing	No significant effects on health and wellbeing have been identified at this level of detail.	
Transport	The site is located at significant distance (c.4.4km) to the services and facilities located in Overton village centre and main bus routes. It is also located approximately 3.7km from the railway station.	
Economy and enterprise	The delivery of new housing will support the viability of agricultural uses in the vicinity of the site.	

Key		
Likely adverse effect (without mitigation measures)		Likely positive effect
Neutral/no effect		Uncertain effects

Appraisal of alternative site packages for taking forward through the ONP

- 6.2.12 Following the shortlisting of the ten potential sites, the Steering Group liaised with the landowners of the sites to determine 1) their preferences in terms of the location and scale of new development, and 2) what would be acceptable to the landowners in terms of scale and phasing at each site. Drawing on these consultations, three 'scenarios', or options were developed for delivering 154 dwellings (i.e. a figure slightly above that currently proposed through the Basingstoke and Deane Local Plan). These scenarios were as follows:

Table 6.3 Scenario A

Site	Number of dwellings
Site F: S of Two Gate Lane	70
Site J: W of Sapley Lane Playing Field	55
Site B: E of Court Drove	14
Site A: NW of Primary School	5
Site WW: Willesley Warren	5
Site AW: Ashe Warren	5
Total	154

Table 6.4 Scenario B

Site	Number of dwellings
Site F: S of Two Gate Lane	125
Site B: E of Court Drove	14
Site A: NW of Primary School	5
Site WW: Willesley Warren	5
Site AW: Ashe Warren	5
Total	154

Table 6.5 Scenario C

Site	Number of dwellings
Combination of Site J: W of Sapley Lane Playing Field and Site K: W of Pond Close	125
Site B: E of Court Drove	14
Site A: NW of Primary School	5
Site WW: Willesley Warren	5
Site AW: Ashe Warren	5
Total	154

- 6.2.13 The SA process appraised these three scenarios as further 'reasonable alternatives' against both the baseline and relatively (i.e. against each other). As for the previous options considered, these were considered through the SA Framework of objectives and appraisal questions developed during scoping. The three scenarios have also been ranked in terms of their sustainability performance against the relevant topic. The findings of the appraisal are presented in **Table 6.6**.

Table 6.6 Appraisal findings: Site packages

Sustainability theme	Discussion of potential effects of three scenarios and relative merits	Rank of sustainability performance in relation to sustainability theme		
		Scenario A	Scenario B	Scenario C
Biodiversity	<p>Site A: <i>NW of Primary School</i> and Site AW: <i>Ashe Warren</i> are both located adjacent to areas of Biodiversity Action Plan Habitat (Deciduous Woodland). Alongside, both Site A: <i>NW of Primary School</i> and Site B: <i>E of Court Drove</i> are located in close proximity to the Court Drove Woodland Strip Site of Importance for Nature Conservation. In this respect, through taking forward the four smaller sites, all three scenarios have the potential to have effects on these locally important biodiversity sites without mitigation and avoidance measures. Site F: <i>S of Two Gate Lane</i> is also located adjacent to an area of Deciduous Woodland Biodiversity Action Plan Habitat, potentially leading to effects from Scenarios 1 and 2.</p> <p>SSSI Impact Risk Zones are a GIS tool/dataset which maps zones around each Site of Special Scientific Interest according to the particular sensitivities of the features for which it is notified. They specify the types of development that have the potential to have adverse impacts at a given location. Natural England is a statutory consultee on development proposals that might impact on SSSIs. In relation to the River Test SSSI, all of the sites proposed within Overton village are within an SSSI Impact Risk Zone for development which comprises 100 residential dwellings or more. In this context, through seeking to take forward 125 dwellings at one location, both Scenario 2 and 3 raise the possibility of adverse effects on the River Test SSSI without avoidance and mitigation measures.</p> <p>All sites have the potential to have impacts on biodiversity assets if located inappropriately and have poor design and layout. Likewise all sites have the potential to promote net gains in biodiversity value. In this context, for all scenarios, potential effects on biodiversity depend on aspects such as the provision of enhanced green infrastructure networks to accompany new development areas and the retention and incorporation of biodiversity features within new housing development.</p>	1	3	2

Sustainability theme	Discussion of potential effects of three scenarios and relative merits	Rank of sustainability performance in relation to sustainability theme		
		Scenario A	Scenario B	Scenario C
Climate change (including flood risk)	<p>In terms of greenhouse gas emissions, road transport is an increasingly significant contributor to emissions in the Overton Neighbourhood Plan Area. Therefore, the extent to which the three scenarios have the potential to support climate change mitigation through facilitating a reduced level of car dependency is a key element. In this context all three scenarios will take forward the two sites located at some distance from the village (Site WW: <i>Willesley Warren S</i> and Site AW: <i>Ashe Warren</i>). This will increase the need to travel and promote car use for those living in new residential areas at these locations.</p> <p>The other proposed sites are located in the immediate vicinity of Overton village with its range of services, facilities, amenities and public transport links. This will support climate change mitigation through limiting the need for residents to travel. It is uncertain however at this level of detail which of the three scenarios are likely to contribute most to limiting greenhouse gas emissions over an annual period.</p> <p>In relation to adapting to the effects of climate change, according to the Strategic Flood Risk Assessment no sites proposed through the scenarios are located within identified flood risk zones for fluvial or surface water flooding. All sites are also located entirely within Flood Zone 1. The extent to which new allocations support climate change adaptation will therefore depend on elements such as the extent to which enhanced open space provision is integrated within new development areas, the design and layout of new housing allocations and the integration of sustainable drainage systems.</p>	1=	1=	1=
Land, soil and water resources	<p>Land at Site A: <i>NW of Primary School</i>, Site B: <i>E of Court Drove</i>, Site F: <i>S of Two Gate Lane</i>, and Site K: <i>W of Pond Close</i> has been classified as Grade 3a agricultural land. This is land classified as the Best and Most Versatile Agricultural Land. Recent surveys of agricultural land classification have not been carried out for Site J: <i>W of Sapley Playing Field</i>, Site WW: <i>Willesley Warren S</i> and Site AW: <i>Ashe Warren</i>. It is therefore uncertain as to whether land at these locations comprises the Best and Most Versatile Agricultural Land.</p> <p>Overall Scenario 2, through focussing more development on Site F: <i>S of Two Gate Lane</i> has the potential lead to an increased loss of the Best and Most Versatile Land. This however largely depends on the detailed location of development and the integration of land uses which prevent the sterilisation of higher quality agricultural land, such as the provision of new allotments.</p> <p>The scenarios' effect on water quality and availability will depend on the elements such as the detailed design and layout of new development, the integration of water efficiency measures and the implementation of sustainable drainage systems to accompany new development. All of the sites are underlain by a principle aquifer (chalk), which is vulnerable to polluting activities.</p> <p>Southern Water has indicated that there would be insufficient capacity for larger scale development at Site F: <i>S of Two Gate Lane</i> location (above 20 dwellings). However additional capacity could come forward as part of new development.</p>	1=	3	1=

Sustainability theme	Discussion of potential effects of three scenarios and relative merits	Rank of sustainability performance in relation to sustainability theme		
		Scenario A	Scenario B	Scenario C
Historic environment and landscape	<p>In relation to the North Wessex Downs AONB, all three scenarios allocate two sites (Site WW: <i>Willesley Warren S</i> and Site AW: <i>Ashe Warren</i>) within the AONB. Whilst both of the allocations are small in scale (comprising c. 5 dwellings each), these have the potential to lead to adverse effects on the integrity of the AONB, even with the implementation of careful design and layout and the integration of appropriate landscaping.</p> <p>The remaining sites proposed through the scenarios are located outside of the AONB. In this context the larger-scale allocations proposed through the three scenarios are located to the south and south east of Overton. Due to the topography of the village, which rises from the River Test, the sites' location on the edge of the village adjoining open countryside may lead to effects on views from the south and east of Overton, and potentially longer distance views from higher elevation locations in the AONB to the north.</p> <p>In terms of broader impacts on landscape and townscape quality, Scenario 2 is likely to have increased impacts to the east of the village, and Scenario 3 is likely to have increased impacts to the south west of the village. In this context through concentrating new housing provision on fewer and larger sites, Scenarios 2 and 3 have the potential to lead to increased impacts on landscape quality in the vicinity of these two locations through potential loss of landscape features, visual impacts and impacts on noise quality linked to increased traffic flows. Whilst Scenario 1 will have impacts at both locations, due to the reduced scale of proposed development, effects on landscape and townscape quality at each location are likely to be moderated in comparison to Scenarios 2 and 3.</p> <p>In terms of historic environment assets, the southern part of Site B: <i>E of Court Drove</i> extends into the Overton Conservation Area, and is close to the three listed structures at Court Farm. None of the other sites are located adjacent to, or in close proximity to the conservation area, listed buildings or scheduled monuments (with the exception of WW: <i>Willesley Warren S</i>, which is located 250m north east from the long barrow scheduled monument). In terms of overall effects, there are negligible differences between the sustainability performance of the three scenarios in relation to the historic environment.</p>	1	2=	2=
Population and community	<p>All three scenarios propose a total of 144 dwellings (out of 154) at sites located adjacent to Overton. This will support the development of housing at locations which are more easily accessible to existing services, facilities and amenities in the village, including health and leisure facilities. This will also support accessibility to the public transport networks present in the village.</p> <p>In terms of the remaining ten dwellings, all three scenarios will take forward the two relatively inaccessible sites located at some distance from the village (Site WW: <i>Willesley Warren S</i> and Site AW: <i>Ashe Warren</i>). It should be noted however that the allocations at these locations are designed to provide housing for families engaged in farming locally.</p>	1=	1=	1=

Sustainability theme	Discussion of potential effects of three scenarios and relative merits	Rank of sustainability performance in relation to sustainability theme		
		Scenario A	Scenario B	Scenario C
Health and wellbeing	<p>Each of the three scenarios propose a total of 144 dwellings (out of 154) at sites located adjacent to Overton. This will support accessibility to health services and leisure and recreational facilities in the village and promote the viability of such amenities. This will support the health and wellbeing of residents. Locating more housing in close proximity to village amenities will also encourage walking and cycling, which are healthier modes of travel.</p> <p>Overall, in terms of likely significant effects, there are negligible differences between the sustainability performance of the three scenarios in relation to the health and wellbeing sustainability theme. Effects on health and wellbeing will depend on factors such as the provision of new services and facilities to accompany new development, the quality and energy efficiency of new housing, and enhancements to open space provision and green infrastructure networks, including pedestrian and cycle links.</p>	1=	1=	1=
Transportation	<p>All three scenarios propose a total of 144 dwellings (out of 154) at sites adjacent to Overton. This will support the development of housing at locations with good access by walking and cycling to existing services, facilities and amenities in Overton. This will also support accessibility to the public transport networks serving the village, promoting the use of alternatives to the car.</p> <p>All three scenarios will take forward the two relatively inaccessible sites located at some distance from the village (Site WW: <i>Willesley Warren S</i> and Site AW: <i>Ashe Warren</i>). This will increase the need to travel for those living at these locations and encourage car use. It should be noted however that the allocations at these locations are designed to provide housing for families engaged in farming locally. This will support access for those engaged in agricultural activities.</p>	1=	1=	1=
Economy and enterprise	<p>The three scenarios all propose a total of 144 dwellings (out of 154) at sites adjacent to Overton. In this context all three scenarios have the potential to support the viability and vitality of the village, including through supporting local shops and amenities.</p> <p>In terms of the remaining ten dwellings, all three scenarios will take forward Site WW: <i>Willesley Warren S</i> and Site AW: <i>Ashe Warren</i>. Neighbourhood Plan allocations at these locations are designed to provide housing for families engaged in farming locally. This will support the viability of agricultural activities at these locations.</p>	1=	1=	1=

6.2.14 The findings described above were presented with the other Neighbourhood Plan information at the consultation event undertaken in late January 2015.

6.2.15 Responses on the consultation event highlighted that there was a preference for Scenario A to be taken forward as the spatial strategy for the Neighbourhood Plan. For this reason, the current version of the ONP takes forward this scenario as the preferred spatial strategy for the Neighbourhood Plan.

6.3 Development of Neighbourhood Plan policies

6.3.1 To support the implementation of the Vision and Objectives for the Neighbourhood Plan discussed in section 2.4, and to complement the proposed sites for development, the Regulation 14 consultation version of the ONP (February 2015) put forward 20 policies to guide development in the Neighbourhood Area. These were developed following extensive community consultation and evidence gathering.

6.3.2 The policies were grouped into the following categories:

- Landscape, the built environment and local distinctiveness
- Housing
- Working
- Shops and services
- Learning and skills
- Getting around
- Community services
- Enjoyment and recreation

6.3.3 To provide context on their sustainability performance, the SA Report accompanying the Regulation 14 consultation version of the ONP (February 2015) presented an appraisal of these policies.

6.3.4 The key recommendations arising from this appraisal were as follows:

- The next iteration of the ONP should seek to encourage the integration of high levels of sustainability into new housing development in the Neighbourhood Area. This includes relating to energy efficient design, water efficiency, water reuse and the integration of climate-resilience into new development areas.
- The ONP should seek to ensure that all development in and adjacent to the Overton Conservation Area is carried out in conjunction with the Conservation Area Appraisal undertaken for the area.

6.3.5 The appraisal also highlighted that, even with the policy approaches proposed, it could not be shown that the proposed allocations for Site WW: Willesley Warren S and Site AW: Ashe Warren would not have adverse effects on the integrity of the North Wessex Downs AONB.

6.4 Changes made to the ONP following Regulation 14 consultation

6.4.1 Following Regulation 14 consultation on the ONP, the Neighbourhood Plan was updated to take into account responses received during the six week period of consultation. The ONP was also updated to reflect the recommendations included in the SA Report accompanying the Regulation 14 consultation version of the ONP. This included relating to the site allocations to be taken forward through the Neighbourhood Plan, as described below:

Discontinuing of Site WW: Willesley Warren S and Site AW: Ashe Warren as sites for the Neighbourhood Plan

- 6.4.2 Concerns were raised during consultation relating to the location of site *Site WW: Willesley Warren S* and *Site AW: Ashe Warren* within the North Wessex Downs AONB, as well as their relative distance from the services and facilities in Overton. This reflected the findings of the SA process, which were presented in the SA Report accompanying the Regulation 14 version of the ONP.
- 6.4.3 In light of consultation responses, it was therefore decided that the taking forward these sites forward for the purposes of the Neighbourhood Plan was inconsistent with the other policies of the ONP. As such it was viewed by the Neighbourhood Plan Steering Group that the most appropriate course of action was to transfer the 5 dwellings previously proposed for *Site WW: Willesley Warren S* to *Site A: NW of Primary School*. A further dwelling was added to this site to help ensure that the delivery of 40% affordable houses would be secured at this site, through increasing the number of dwellings taken forward to 11 dwellings.
- 6.4.4 Whilst the 5 dwellings previously allocated to *Site AW: Ashe Warren* have not been reallocated, it was viewed that this was not required as the ONP would continue to deliver the 150 dwellings stipulated through the Local Plan.

6.4.5 Reserve sites

- 6.4.6 Following consultation on the Regulation 14 version of the ONP, it was also viewed that the choice of the three reserve sites proposed (Site M: W of Vinn's Lane, Site E: E of Overton Hill Car Park and Site PB: Popham Beacons) should be revisited. This reflected 1) a desire to ensure that affordable housing could be successfully delivered through an appropriate reserve site and 2) the various constraints and sustainability issues (including as highlighted through the SA process) associated with the previously chosen reserve sites.
- 6.4.7 As such, the southern part of Site K: West of Pond Close was nominated as an appropriately sized reserve site for potentially delivering up to 70 dwellings (as per the risk assessment) if any of the other sites allocated through the Neighbourhood Plan became unavailable. The choice of this site drew on the findings of the appraisal of the various sites undertaken through the SA process (see section 6.2.11). As such the southern part of the site was chosen to limit effects on the SINC in the north and the safeguarded minerals area.
- 6.4.8 Part 3 of this SA Report considers the updated version of the ONP policies and allocations through appraising the current Submission version of the plan.

6.5 Consideration of Site D: Great North Field

- 6.5.1 Site D: Great North Field is available and is being promoted by the developer. It was assessed by the ONP Steering Group in the same way as all other sites, including the sustainability considerations. However, in October 2014, the developer indicated that 150 dwellings was the minimum number and would not consider phasing.
- 6.5.2 At the public consultations in November 2014, the strategic option of all 150 dwellings on a single site without phasing was decisively rejected by residents. There was also strong opposition from residents to development of this site throughout the consultation process. On December 3rd 2014, the developer presented plans for 'up to 275' dwellings on site D and has never committed to restricting the number to 150.
- 6.5.3 The ONP Steering Group considered that, on the basis of the developer's intentions, Site D was not a reasonable alternative for inclusion in the Neighbourhood Plan because it would stand so little

chance of being approved at referendum that it could not be regarded as being deliverable within the ONP. It was therefore not included in the 'scenarios' presented on January 24th 2015.

6.5.4 Nevertheless, the site is available and should be appraised for 150 dwellings alongside the sites which have been put forward by the preferred approach for the Neighbourhood Plan.

6.5.5 The appraisal of the site as a location for 150 dwellings has been presented in **Table 6.7** below:

Table 6.7 Appraisal of Great North Field proposal



SA topic	Commentary, Site D: Great North Field	
Biodiversity	<p>The northern and western boundaries of the Great North Field comprise Deciduous Woodland Biodiversity Action Plan Habitat. The Court Drove Site of Importance for Nature Conservation is located on the western boundary of the site. The site is also located within the River Test SSSI's Impact Risk Zone⁵² for the types of development which have the potential to have adverse impacts (in this case, residential developments of 100 dwellings or more). Due to its arable agricultural use, the majority of the site is however of low biodiversity value.</p> <p>The delivery of biodiversity enhancements to accompany new development may be more achievable through a larger scale of allocation proposed through the development of 150 dwellings. This includes through green infrastructure improvements and enhancements to ecological corridors and the ecological value of existing biodiversity assets. However, the higher housing numbers proposed for this one site has the potential to lead to an increased magnitude of effects on habitats and species without careful planning of development and the delivery of mitigation and avoidance measures.</p>	
Climate change	<p>In terms of climate change mitigation, road transport is an increasingly significant contributor to greenhouse gas emissions in the plan area. The extent to which the site has the potential to support climate change mitigation through facilitating a reduced level of car dependency is therefore a key element. In this context, Site D is located in closer proximity to Overton railway station than many of the sites proposed through the preferred spatial approach for the ONP. This will support the use of rail and reduce the need to travel by the private car. Through promoting a larger scale of development, the proposal may also enable more effective improvements to walking and cycling and public transport networks through the infrastructure opportunities afforded by larger allocations. The site is also located in relative proximity (0.6km) to the village centre.</p> <p>It should be noted however that the development of 150 dwellings at this location will lead to inevitable increases in the carbon footprint of the parish.</p> <p>In terms of climate change adaptation, enhancements to the plan area's green infrastructure networks will be a key means of helping the Neighbourhood Area adapt to the effects of climate change. This includes through helping to regulate extreme temperatures and regulate surface water run-off. In this respect, the direct provision of green infrastructure improvements to accompany new development areas may be more deliverable through the larger scale proposals put forward through this proposal.</p>	

⁵² SSSI Impact Risk Zones are a GIS tool/dataset which maps zones around each SSSI according to the particular sensitivities of the features for which it is notified. They specify the types of development that have the potential to have adverse impacts at a given location. Natural England is a statutory consultee on development proposals that might impact on SSSIs.

SA topic	Commentary, Site D: Great North Field	
Land, soil and water resources	<p>Development at this site has the potential to lead to the loss of Grade 3a agricultural land (which is classified as the Best and Most Versatile Agricultural Land).</p> <p>Village-wide, Southern Water has stated that there is limited spare capacity in the sewerage system for new development. In common with all proposed sites, the site is located within a eutrophic and groundwater nitrate vulnerable zone.</p> <p>In terms of water quality, it is difficult to come to a conclusion regarding the potential for development at this location to result in negative effects without an understanding of the design measures that will be put in place. For example sustainable drainage systems – SuDS – are an effective means of minimising surface water runoff and hence pollution. However due to the topography of the site there are some doubts raised as to the effectiveness of Sustainable Drainage Systems on the site.</p>	
Historic environment and landscape	<p>Through concentrating new housing provision on one large site, the development of 150 dwellings at this location has increased potential to lead to impacts on landscape quality. This includes through loss of landscape features, visual impacts and impacts on noise quality linked to increased traffic flows. In relation to potential effects on the North Wessex Downs AONB, the Great North Field site is located adjacent to the AONB boundary. Whilst the site is screened by the railway line embankment and topography, longer distance views from and to the AONB may be adversely affected by development at the site. Development of the site however provides opportunities for managing the landscape impacts of the housing provision.</p> <p>In terms of potential effects on the historic environment, the setting of the two Grade II* listed buildings located 200m to the south of the Great North Field site have the potential to be affected by development at this location. A small part of the Great North Field site is located adjacent to the Overton Conservation Area boundary to the east.</p> <p>According to the Overton element of the Extensive Urban Survey⁵³, an area of High Archaeological Importance has been identified in the vicinity of the church and Court Farm.</p>	
Population and community	<p>The larger scale development proposed for this site will help deliver a wider range of housing types. Due to the size of the allocation, the delivery of affordable housing provision is likely to be supported. This is linked to the enhanced viability of delivering affordable housing through larger scale developments, and recent legislation which introduces a 10 unit threshold for affordable housing contributions.</p> <p>Whilst all new developments involving one or more dwellings are liable for the community infrastructure levy, concentrating the delivery of housing at one large site may help enable the securing of additional contributions to site specific mitigation through Section 106 planning agreements.</p> <p>In terms of the impact of new housing provision on existing pressures on community services and facilities, the effect of development at this location depends on the extent to which new housing provision is accompanied by new, expanded and improved health, educational and service provision in the Neighbourhood Area. The delivery of new and improved community facilities may however be supported by the scale of development proposed through this proposal.</p>	

⁵³ English Heritage (2004) Extensive Urban Survey - Hampshire and the Isle of Wight
http://archaeologydataservice.ac.uk/archives/view/hampshire_eus_2003/downloads.cfm?REDSQUIDARCHIVES_2699_096EB00F-1F77-420B-98A692541C22AE2E&area1=basinstoke&area2=overton

Health and wellbeing	<p>The delivery of the larger scale of housing provision through the allocation of 150 dwellings at this location has the potential to concentrate effects on road safety and noise quality from increased traffic flows at certain locations. This may have effects on the health and wellbeing of residents at these locations.</p> <p>The delivery of new and improved health services and green infrastructure enhancements may however be supported by the larger scale of development put forward through this proposal.</p>	
Transport	<p>The site is located in good proximity to Overton railway station. This will support the use of rail and limit the need to travel by the private car for longer journeys. The site is also located in relative proximity (0.6km) to the village centre, which will promote walking and cycling to local facilities.</p> <p>Through promoting a larger scale of development, the proposal may enable more effective improvements to walking and cycling and public transport links through the infrastructure opportunities afforded by larger allocations (although it is uncertain where these links could be developed). However, the more focussed nature of development proposed has the potential to lead an increased impacts on traffic flows and congestion in this part of Overton.</p>	
Economy and enterprise	<p>The scale of development proposed through the proposal has the potential to support the economic viability and vitality of the village. This includes through supporting local shops and amenities and promoting economic opportunities.</p>	

Key		
Likely adverse effect (without mitigation measures)		Likely positive effect
Neutral/no effect		Uncertain effects

This page is intentionally blank]

Part 3: What are the appraisal findings at this current stage?

7 Introduction to Part 3

The report must include...

- The likely significant effects associated with the draft plan approach
- The measures envisaged to prevent, reduce and as fully as possible offset any significant adverse effects of implementing the draft plan approach

The aim of Part 3 is to present appraisal findings and recommendations in relation to the current Submission version of the ONP. Part 3 is structured as follows:

- Chapter 8 presents an appraisal of the Submission version of the ONP under the eight 'SA topic' headings; and
- Chapter 9 discusses overall conclusions at this current stage and recommendations.

8 Appraisal of the current Submission version of the ONP Plan

8.1 Introduction

- 8.1.1 The appraisal is structured under the eight 'topic' headings discussed. For each topic a range of sustainability objectives are listed, which are further supported by the decision-making questions developed during scoping. Taken together, these provide the assessment framework for the appraisal of likely significant effects on the baseline (**Appendix II**).
- 8.1.2 Every effort is made to predict effects accurately; however, this is inherently challenging given the strategic nature of the plan. The ability to predict effects accurately is also limited by understanding of the baseline as a result of incomplete data. Because of the uncertainties involved, there is a need to exercise caution when identifying and evaluating significant effects and ensure assumptions are explained in full.⁵⁴ In many instances it is not possible to predict significant effects, but it is possible to comment on merits (or otherwise) in more general terms.
- 8.1.3 It is important to note that effects are predicted taking into account the criteria presented within Schedule 2 of the SEA Regulations.⁵⁵ So, for example, account is taken of the probability, duration, frequency and reversibility of effects as far as possible. Cumulative effects are also considered (i.e. where the effects of the Plan may combine with the effects of other planned or on-going activity that is outside the control of the ONP). These effect 'characteristics' are described within the appraisal as appropriate.

⁵⁴ As stated by Government Guidance (The Plan Making Manual, see <http://www.pas.gov.uk/pas/core/page.do?pagelid=156210>):

"Ultimately, the significance of an effect is a matter of judgment and should require no more than a clear and reasonable justification."

⁵⁵ Environmental Assessment of Plans and Programmes Regulations 2004

8.2 Biodiversity

Relevant sustainability objectives

SA Objectives	SA appraisal Questions:
Protect and enhance all biodiversity and geological features	<p>Will the option/proposal help to:</p> <ul style="list-style-type: none"> • Support continued improvements to the status of the River Test SSSI? • Support continued improvements to the status of the Micheldever Spoil Heaps SSSI? • Protect and enhance the integrity of the SINCs present in the plan area? • Protect and enhance semi-natural habitats? • Protect and enhance priority habitats, and the habitat of priority species? • Achieve a net gain in biodiversity? • Support access to, interpretation and understanding of biodiversity and geodiversity?

Summary of the appraisal of the Submission version of the Plan

- 8.2.1 A number of the proposed sites for allocation have the potential to lead to adverse effects on biodiversity interest without the introduction of appropriate mitigation and enhancement measures.
- 8.2.2 SSSI Impact Risk Zones are a GIS tool/dataset which maps zones around each SSSI according to the particular sensitivities of the features for which it is notified. They specify the types of development that have the potential to have adverse impacts at a given location. Natural England is a statutory consultee on development proposals that might impact on SSSIs. In this context, whilst a number of the sites are in relatively close proximity to the River Test SSSI, no sites are within the established Impact Risk Zone for the SSSI. This is due to the limited size of the allocations proposed through the ONP (i.e. under 100 dwellings).
- 8.2.3 The Hampshire Biodiversity Action Plan (BAP) identifies a number of 'priority habitats' that are characteristic of Hampshire and for which Hampshire makes a significant contribution to the UK aims of the Biodiversity Action Plan. In this context the allocations proposed at **Site A: NW of Primary School** is located adjacent to areas of Biodiversity Action Plan Habitat (Deciduous Woodland). In relation to Sites of Importance for Nature Conservation, **Site A: NW of Primary School** and **Site B: E of Court Drove** are located in close proximity to the Court Drove Woodland Strip SINC.
- 8.2.4 In terms of the proposed reserve site, the north western edge of **Site K: West of Pond Close** overlaps with the Overton Green Lanes and Sunken Tracks Site of Importance for Nature Conservation.
- 8.2.5 The current version of the ONP sets out a number of provisions which will help limit potential effects from allocations on features and areas of biodiversity interest in the Neighbourhood Area. For example **Policy H3** seeks to ensure that developers are '*consult with and are guided by Overton Biodiversity Society and Hampshire and IOW Wildlife Trust in their planting plans and make provision for ongoing habitat management and create/enhance wildlife corridors in a manner that is proportionate to the size of development*'. The policy also seeks to ensure that proposals mirror the provisions of the Basingstoke and Deane Green Infrastructure Strategy. The policy is reinforced by **Policy E3** which seeks to ensure that new open space reflects the provisions of the Green Infrastructure Strategy and new access to open spaces is '*guided by Overton Biodiversity Society, Hampshire and Isle of Wight Wildlife Trust and Natural England to prevent loss of important habitats or biodiversity*' and '*proposals leading to their loss will be opposed*'.
- 8.2.6 **Policy E2** supports the integrity of sites designated by their biodiversity value in the Neighbourhood Area through reiterating that new development conforms to Local Plan policies for the River Test SSSI and the SINCs present in the parish.

8.3 Climate Change

Relevant sustainability objectives

SA Objectives	SA appraisal Questions:
Promote climate change mitigation in Overton	<p>Will the option/proposal help to:</p> <ul style="list-style-type: none"> • Limit the increase in the carbon footprint of the plan area from population growth? • Promote the use of sustainable modes of transport, including walking, cycling and public transport? • Reduce the need to travel? • Increase number of new developments meeting sustainable design criteria? • Improve green infrastructure networks in the plan area to support adaptation to the potential effects of climate change? • Generate energy from low or zero carbon sources? • Reduce energy consumption from non-renewable resources?
Support the resilience of Overton to the potential effects of climate change	<p>Will the option/proposal help to:</p> <ul style="list-style-type: none"> • Ensure that no development takes place in areas at higher risk of flooding, taking into the likely effects of climate change into account? • Sustainably manage water run-off, ensuring that the risk of flooding is not increased (either within the plan area or downstream) and where possible reduce flood risk? • Ensure the potential risks associated with climate change are considered through new development in the plan area? • Increase the resilience of biodiversity in the plan area to the effects of climate change?

Summary of the appraisal of the Submission version of the Plan

- 8.3.1 In terms of climate change mitigation, road transport is an increasingly significant contributor to greenhouse gas emissions in the plan area. In this context **Policy T1** seeks to ensure that new developments ‘*provide multi-use paths linking the development to existing and new planned routes to amenities, public transport routes and existing footpaths.*’ This will support walking and cycling as an alternative to the private car, promoting climate change mitigation.
- 8.3.2 All of the proposed site allocations are located in the immediate vicinity of Overton village with its range of services, facilities, amenities and public transport links. This will support climate change mitigation through limiting the need for residents to travel by the private car and limiting the need to travel.
- 8.3.3 Further support climate change mitigation, **Policy H3** seeks to ensure that ‘*proposals achieve best practice in energy efficiency and generation compatible with the financial viability of the scheme*’ whilst also acknowledging that this is unlikely to affect the viability of new housing in the Neighbourhood Area.
- 8.3.4 Enhancements to green infrastructure networks promote climate change mitigation through supporting carbon sequestration and promoting sustainable modes of transport, and climate change adaptation through helping to limit the effects of extreme weather events and regulating surface water run-off. In this context the plan’s focus on the protection and enhancement of green infrastructure provision in the Neighbourhood Area will support these elements. In particular **Policies H3 and E3** will help protect and enhance open spaces and support improvements to green infrastructure networks, including in conjunction with the Basingstoke and Deane Green Infrastructure Strategy.

- 8.3.5 **Policy H3** will further help increase the resilience of ecological networks to the effects of climate change through making provision for habitat management and enhancing biodiversity corridors.
- 8.3.6 In relation to flood risk in the Neighbourhood Area, the addressing of issues linked to fluvial, groundwater and surface water flooding are likely to be supported by the provisions of the NPPF. Likewise, the flood risk, SuDS and surface water flooding policies proposed by the Basingstoke and Deane Local Plan would further help limit adverse effects in this regard. However **Policy H4** reiterates that accompanying new development, a '*viable drainage plan*' should be in place '*for adequate capacity for land drainage and it is demonstrated that the risk of flooding is not increased*'.
- 8.3.7 Policy H4 also seeks to ensure that opportunities for sustainable urban drainage systems and reducing permeable water run-off according to best practice guidelines are maximised and applicants agree a viable foul water sewage disposal plan with Southern Water

8.4 Land, soil and water resources

Relevant sustainability objectives

SA Objectives	SA appraisal Questions:
Ensure the more efficient use of land.	Will the option/proposal help to: <ul style="list-style-type: none"> Promote the use of previously developed land? Avoid the development of the best and most versatile agricultural land, in particular Grade 2 and Grade 3a agricultural land?
Promote sustainable waste management solutions that encourage the reduction, re-use and recycling of waste.	Will the option/proposal help to: <ul style="list-style-type: none"> Reduce the amount of waste produced? Move waste up the waste hierarchy? Maximise opportunities for local management of waste in order to minimise export of waste to areas outside? Encourage recycling of materials and minimise consumption of resources during construction?
Use and manage water resources in a sustainable manner.	Will the option/proposal help to: <ul style="list-style-type: none"> Support improvements to water quality? Minimise water consumption? Protect groundwater resources?

Summary of the appraisal of the Submission version of the Plan

- 8.4.1 The ONP exclusively allocates land on greenfield sites, reflecting the lack of brownfield sites available in and around Overton village. Due to the lack of availability of lower quality agricultural land in the vicinity of Overton village, most of the sites proposed have the potential to lead to the loss of the Best and Most Versatile Agricultural Land.
- 8.4.2 In terms of the proposed allocations, land at Site A: NW of Primary School, Site B: E of Court Drove and the reserve Site K: W of Pond Close has been classified as Grade 3a agricultural land. This is land classified as the Best and Most Versatile Agricultural Land. In terms of the productivity of agricultural land, **Policy CS1** seeks to ensure that there is no loss of allotments in the parish. The policy for **Site J: W of Sapley Playing Field** also encourages the provision of allotments at the site.
- 8.4.3 A focus on enhancing open space provision and supporting green infrastructure improvements through **Policy H3** will also help prevent the sterilisation of further areas of the Best and Most Versatile Agricultural Land.
- 8.4.4 In relation to water availability, the ONP seeks to encourage grey water use through Policy H4. Water efficiency within new development areas will also be addressed through national policy and

standards and the emerging Basingstoke and Deane Local Plan. In terms of water quality, all of the proposed sites for allocation are located within a eutrophic and groundwater nitrate vulnerable zone. **Policy H4** also seeks to ensure that opportunities for sustainable urban drainage systems and reducing permeable water run-off according to best practice guidelines are maximised and applicants agree a viable foul water sewage disposal plan with Southern Water.

- 8.4.5 Water quality will be further supported by **Policy H5**, which seeks to ensure that new and improved utility infrastructure for water supply, surface water drainage and foul water sewerage is secured.

8.5 Historic environment and landscape

Relevant sustainability objectives

SA Objectives	SA appraisal Questions:
Protect, maintain and enhance Overton's cultural heritage resource, including its historic environment and archaeological assets.	Will the option/proposal help to: <ul style="list-style-type: none"> • Preserve and enhance the setting of cultural heritage assets? • Support the integrity of the Overton Conservation Area? • Preserve and enhance buildings and structures of architectural or historic interest? • Protect the historic settlement pattern of the villages and hamlets in the plan area? • Conserve and enhance local diversity and distinctiveness? • Support access to, interpretation and understanding of the historic environment?
Protect and enhance the character and quality of landscapes and townscapes.	Will the option/proposal help to: <ul style="list-style-type: none"> • Support the integrity of the North Wessex Downs AONB? • Protect and enhance landscape and townscape features?

Summary of the appraisal of the Submission version of the Plan

- 8.5.1 Following the discontinuing of Site WW: Willesley Warren S and Site AW: Ashe Warren as allocations for the purposes of the Neighbourhood Plan, all of the sites proposed through the Neighbourhood Plan are located outside the North Wessex Downs AONB, which covers the area of the parish located to the north of the railway line.
- 8.5.2 Whilst the proposed site allocations are located outside of the AONB, there may be some limited effects from allocations on views from the AONB. In this context the two larger-scale allocations proposed through the current version of the plan (S of Two Gate Lane and W of Sapley Playing Field) are located to the south and south east of Overton. Due to the topography of the village, which rises from the River Test, these allocations may lead to potential limited (and non-significant) effects on longer distance views from higher elevation locations in the AONB to the north. The larger sites' location on the edge of the village adjoining open countryside may also lead to some effects on views from the south and east of Overton, although it should be noted that the sites are currently well screened from these directions.
- 8.5.3 In terms of historic environment designations, none of the proposed sites are located within the Overton Conservation Area. However one proposed site, **Site B: E of Court Drove** is located adjacent to the conservation area. The same site is also located close to the three listed structures at Court Farm (including the Grade II* listed Court Farmhouse and church, and the Grade II listed barn and stable). The site is also located within an area of High Archaeological Interest. As such development at this location should be carefully managed to ensure that the fabric and setting of these important historic environment features are not adversely affected, appropriate archaeological studies are undertaken and design and layout complements the distinctive historic setting of the area.

- 8.5.4 The policies proposed for the ONP have a close focus on protecting and enhancing landscape and townscape quality in the Neighbourhood Area, and supporting the conservation and enhancement of the historic environment. **Policy LBE1** seeks to ensure that new development areas conform to the Overton Village Design Statement and the Conservation Area Appraisal and the built form of new development '*minimises the visual impact and relates sensitively to the surrounding area*'. In this context the Village Design Statement provides a robust basis for the protection and enhancement of the landscape and townscape quality and the historic environment in the vicinity of Overton through setting out features which local people regard as important and suggesting ways in which these can be maintained and enhanced through a series of development guidelines.
- 8.5.5 Potential effects on the Overton Conservation Area are considered through Policies S2 and E2. In this respect **Policy S2** seeks to support the vitality of the conservation area through limiting changes of use from retail and commercial to private dwellings and **Policy E2** seeks to ensure that development '*...will conform to Local Plan Policies and the management plan for the North Wessex Downs Area of Outstanding Natural Beauty...the Conservation Area and heritage assets and all of their settings.*'
- 8.5.6 **Policies H3 and E3** provide a focus on protecting and enhancing open spaces and supporting improvements to green infrastructure networks. In this context the protection and enhancement of green infrastructure networks will support landscape and townscape quality in the Neighbourhood Area and the setting of the historic environment. Taking this further, the policies also reinforce the linkages between 1) local green infrastructure provision and needs and 2) current work being carried out by Basingstoke and Deane Borough Council, Natural England and other organisations, including in relation to the implementation of the Basingstoke and Deane Green Infrastructure Strategy. This enables a coordinated approach to be taken which will help ensure that the full range of benefits from a high quality green infrastructure network can be realised.

Recommendations

- 8.5.7 Due to the sensitivity of the area around Site B: E of Court Drove, development at this location should be carefully managed through the implementation of the Neighbourhood Plan to ensure that the fabric and setting of these important historic environment features are not adversely affected, appropriate archaeological studies are undertaken and design and layout complements the distinctive historic setting of the area.

8.6 Population and community

Relevant sustainability objectives

SA Objectives	SA appraisal Questions:
Cater for existing and future residents' needs as well as the needs of different groups in the community, and improve equality of access to local, high-quality community services and facilities.	Will the option/proposal help to... <ul style="list-style-type: none"> • Tackle the causes of poverty and deprivation? • Encourage and promote social cohesion and encourage active involvement of local people in community activities? • Increase the ability of 'hard-to-reach' groups to influence decisions? • Minimise fuel poverty? • Maintain or enhance the quality of life of existing local residents?
Reduce poverty and deprivation and promote more inclusive and self-contained communities.	<ul style="list-style-type: none"> • Promote the development of a range of high quality, accessible community, cultural and leisure facilities? • Improve the availability and accessibility of key local facilities, including specialist services for disabled and older people? • Provide a range of housing
Provide everyone with the opportunity to live in good quality, affordable housing, and ensure an appropriate mix of dwelling sizes, types and tenures.	Will the option/proposal help to... <ul style="list-style-type: none"> • Provide an adequate supply of affordable housing? • Support the provision of a range of house types and sizes? • Meet the needs of all sectors of the community? • Provide quality and flexible homes that meet people's needs? • Ensure that best use is made of the existing housing stock? • Promote the use of sustainable building techniques, including use of sustainable building materials in construction? • Provide housing in sustainable locations that allow easy access to a range of local services and facilities? • Achieve minimum housing requirements?

Summary of the appraisal of the Submission version of the Plan

- 8.6.1 The Submission version of the plan puts forward five sites for housing, a provision totalling 150 dwellings. In addition the ONP puts forward a reserve site, part of Site K. It is anticipated that this will enable the requirements of the emerging Basingstoke and Deane Local Plan are met for the Overton area.
- 8.6.2 In this context it is assumed that this growth quantum is appropriate given objectively assessed housing needs arising locally. As such it is considered that the allocations promoted by the current version of the ONP will help meet established housing need in the Neighbourhood Area.
- 8.6.3 In addition to providing sufficient allocations to meet the requirement of the emerging Basingstoke and Deane Local Plan (and as such objectively assessed need), the current version of the ONP sets out a number range of provisions relating to the type and tenure of housing to be provided through the plan through **Policy H1**. This includes relating to the provision of affordable housing and the provision of housing for those with a local connection. The size of the proposed site allocations have also been designed to ensure that they are equal or above the 11 dwelling threshold for affordable housing delivery. The quality of housing will also be supported by **Policy LBE1**, which promotes the implementation of 'Building for Life' standards and emerging 'Home Quality Mark' standards and **Policy H1**, which promotes the provision of housing which meets 'Lifetime Homes' standards, and which meets 'Secured by Design' standards.
- 8.6.4 In terms of the **spatial strategy** for new development, the ONP promotes a distribution strategy which will support the quality of life of residents. In this regard, the majority of the allocated sites, due to their location in Overton village, and their relative proximity to bus routes, services and

facilities and rail services, will support accessibility to services, facilities and amenities in the Neighbourhood Area. This will be reinforced by **Policy S1**'s focus on supporting shops and services in the parish, **Policy S2**'s limitation of a change of use from commercial and retail to residential uses in the historic core of the village and **Policy CS1**'s focus on supporting community provision. This will support community cohesion and promote the vitality of the village. Education and skills will be promoted by **Policy L2**, which seeks to ensure that developer contributions are sought for Overton Primary School and Overton Library, and **Policy L1**, which encourages an expansion of nursery school facilities in line with demand.

- 8.6.5 The quality of life of residents will also be promoted by **Policy E1**'s support for an increase in the quality and range of social, sporting and recreational facilities and the ONP's focus through **Policies H3, E3 and T1** on the protection and enhancement of green infrastructure networks in the parish. The ONP also has a strong focus on local distinctiveness and the protection and enhancement of townscape and landscape quality (section 8.5). This will contribute to the satisfaction of residents with their neighbourhood as a place to live.

8.7 Health and wellbeing

Relevant sustainability objectives

SA Objectives	SA appraisal Questions:
Improve the health and well-being of Overton's residents.	Will the option/proposal help to: <ul style="list-style-type: none"> Promote accessibility to a range of leisure, health and community facilities, for all age groups? Encourage healthy lifestyles and reduce health inequalities? Provide and enhance the provision of community access to green infrastructure, in accordance with national standards? Improve access to the countryside for recreation?

Summary of the appraisal of the Submission version of the Plan

- 8.7.1 **Policies H3 and E3** provide a focus on protecting and enhancing open spaces and supporting improvements to green infrastructure networks. This includes through improving public access to the countryside and riverside for walkers. This will be supported by **Policy T1**, which seeks to encourage the provision of '*multi-use paths linking the development to existing and new planned routes to amenities, public transport routes and existing footpaths*'. In this context the draft plan's impetus on green infrastructure enhancements will support the health and wellbeing of residents by facilitating improvements in levels of physical activity, enhancing social interaction between residents and promoting psychological well-being.
- 8.7.2 Taking this further, the policies also reinforce the linkages between 1) local green infrastructure provision and needs and 2) current work being carried out by Basingstoke and Deane Borough Council, Natural England and other organisations, including in relation to the implementation of the Basingstoke and Deane Green Infrastructure Strategy. This enables a coordinated approach to be taken which will help ensure that the full range of multifunctional benefits from a high quality green infrastructure network can be realised
- 8.7.3 The health and wellbeing of residents will also be promoted by **Policy E1**'s support for an increase in the quality and range of social, sporting and recreational facilities, and **Policy CS1**'s focus on supporting community provision in the parish, including the provision of allotments.
- 8.7.4 The quality of new housing in the parish will be supported by **Policy LBE1**, which promotes the implementation of 'Building for Life' standards and the emerging 'Home Quality Mark' standards, and **Policy H1**, which promotes the provision of housing meeting 'Lifetime Homes' standards and 'Secured by Design' standards. This will promote health and wellbeing.

8.8 Transportation

Relevant sustainability objectives

SA Objectives	SA appraisal Questions:
Promote sustainable transport use and reduce the need to travel.	Will the option/proposal help to: <ul style="list-style-type: none"> • Reduce the need to travel through sustainable patterns of land use and development? • Encourage modal shift to more sustainable forms of travel? • Enable transport infrastructure improvements?

Summary of the appraisal of the Submission version of the Plan

- 8.8.1 The sites proposed for allocations, due to their proximity to the services and facilities of the main settlement in the Neighbourhood Area (Overton village), and their relative proximity to rail services and bus routes, will support the use of alternative modes of transport to the car and the viability of public transport networks in the Neighbourhood Area. Two sites are however located at relative distance from the services and facilities located in Overton village centre and main bus routes (**Site J: W of Sapley Lane Playing Field**, c. 1.1km from the village centre, and **Site A: NW of Primary School**- c.1km). As such the development of these sites should be accompanied by the further exploration of local public transport infrastructure improvements, such as expansion of the 74 bus service which connects areas within the village that are not served by Stagecoach.
- 8.8.2 The current version of the ONP has a close focus on improving transport options in the parish. In this context **Policies W1, CS1 and T2** seek to ensure that there is sufficient access to housing, employment and services by a range of transport modes and seek to limit the impact of new development areas on traffic and congestion in the parish. **Policies H3 and E3** provide a focus on protecting and enhancing open spaces and supporting improvements to green infrastructure networks. This includes through improving public access to the countryside and riverside for walkers. This will promote walking and cycling. The use of sustainable modes of transport will also be supported by **Policy T1**, which seeks to encourage the provision of 'multi-use paths linking the development to existing and planned new routes to amenities, public transport routes and existing footpaths'.

8.9 Economy and enterprise

Relevant sustainability objectives

SA Objectives	SA appraisal Questions:
Enhance the vitality and viability of the Neighbourhood Area	Protect and enhance the community offer of Overton and the range of services and facilities available? Support the economy of the Neighbourhood Area and provide access to employment opportunities?

Summary of the appraisal of the Submission version of the Plan

- 8.9.1 The current version of the ONP allocates one employment site at Quidhampton Business Unit. The vitality and viability of the parish's economy will also be supported by the housing allocations proposed through the plan. This will be reinforced by **Policy S1's** focus on supporting shops and services in the parish, **Policy S2's** limitation of a change of use from commercial and retail to residential uses in the historic core of Overton village and **Policy CS1's** focus on supporting community provision. The vitality of the parish will also be supported by the ONP's focus on

improving transport options, including through **Policies W1 and T2**, which seek to ensure that there is sufficient access to housing, employment and services by a range of transport modes.

- 8.9.2 In terms of the visitor economy, this will be promoted by **Policy W2**, which supports new overnight tourist accommodation in the parish and supports the modification and extension of premises where visitors can eat, drink and shop. The visitor economy will also be supported by the ONP policies which seek to promote local distinctiveness and character and protect and enhance landscape/townscape quality in the Neighbourhood Area.

9 Conclusions at this current stage

9.1 Potential significant effects

- 9.1.1 The appraisal has concluded that the current version of the ONP is likely to lead to **significant positive effects** in terms of the 'population and community' and 'health and wellbeing' sustainability objectives. These benefits largely relate to the carefully targeted spatial approach proposed by the draft plan, the focus on improving the quality of life of residents in the Neighbourhood Area and the ONP's impetus on protecting and enhancing open space and green infrastructure networks.
- 9.1.2 In terms of potential negative effects, the development of the greenfield sites proposed through the draft plan will lead to inevitable losses of land classified the Best and Most Versatile Agricultural Land. Whilst the ONP has sought to preserve the productivity of some of these areas through promoting allotment provision, residual **significant negative effects** are likely to remain in relation to the 'Land, Soil and Water Resources' sustainability objective.
- 9.1.3 In terms of potential effects on the North Wessex Downs AONB, no site allocations are located within the AONB and the Submission version of the ONP no longer takes forward two previously proposed allocations located in the AONB. Whilst there is potential for the proposed allocations to lead to potential limited effects on longer distance views from higher elevation locations in the AONB to the north, these have not been deemed to be significant.
- 9.1.4 Outside of the AONB, there are likely to be some inevitable effects on landscape and townscape quality from new areas of development on the edge of Overton village. To help address this, the Submission version of the ONP presents a number of policy interventions which will help limit potential effects and achieve enhancements where possible.
- 9.1.5 In terms of potential effects on the River Test SSSI, whilst many of the sites are located in relatively close proximity to the SSSI, adverse effects on this nationally designated nature conservation site are likely to be limited by the proposed size of the allocations. This is reflected by none of the proposed ONP allocations being located within an Impact Risk Zone for the SSSI for the type and scale of development being proposed.
- 9.1.6 Whilst the Submission version of the ONP will help initiate a range of beneficial approaches in relation to 'climate change', 'biodiversity' and 'historic environment and landscape', these are not considered as significant positive effects as the delivery of the allocations through the ONP will inevitably lead to some adverse effects in relation to these sustainability topics. For these topics therefore, the approach put forward through the Submission version of the ONP will limit the potential magnitude of adverse effects linked to the delivery of housing allocations in the Neighbourhood Area.
- 9.1.7 In relation to the 'economy and enterprise' sustainability objective a number of beneficial approaches are put forward by the current version of the plan. This includes relating to a promotion of the parish's visitor economy.

9.2 Recommendations at this current stage

9.2.1 The following recommendations are made at this stage:

- Due to the historic environment sensitivity of the area around Site B: E of Court Drove, development at this location should be carefully managed through the implementation of the Neighbourhood Plan. This should seek to ensure that the fabric and setting of these important historic environment features are not adversely affected, appropriate archaeological studies are undertaken and design and layout complements the distinctive historic setting of the area.
- Two proposed site allocations are located at relative distance from the services and facilities located in Overton village centre and main bus routes (Site J: W of Sapley Lane Playing Field and Site A: NW of Primary School). Development of these sites should be accompanied by the exploration of local transport infrastructure improvements, such as expansion of the 74 bus service which connects areas within the village that are not served by Stagecoach.
- To accompany the development of Site J, the provision of a convenience store.

*Part 4: What are the
next steps?*

10 Introduction to Part 4

10.1.1 This Part of the SA Report explains the next steps that will be taken as part of the plan-making / SA process.

10.2 Plan finalisation

10.2.1 The ONP has been submitted to the Local Planning Authority, Basingstoke and Deane Borough Council, for its consideration. Basingstoke and Deane Borough Council will consider whether the plan is suitable to go forward to Independent Examination in terms of the ONP meeting legal requirements and its compatibility with the Local Plan.

10.2.2 Subject to Basingstoke and Deane Borough Council's agreement, the ONP will then be subject to independent examination. The Examiner will consider whether the plan is appropriate having regard to national policy and whether it is in general conformity with the Local Plan.

10.2.3 The Examiner will be able to recommend that the ONP is put forward for a referendum, or that it should be modified or that the proposal should be refused. Basingstoke and Deane Borough Council will then decide what should be done in light of the Examiner's report. Where the report recommends modifications to the plan, Basingstoke and Deane Borough Council will invite the ONP Steering Group to make modifications to the plan, which will be reflected in an updated SA Report. Where the Examiner's Report recommends that the proposal is to be refused, Basingstoke and Deane Borough Council will do so.

10.2.4 Where the examination is favourable, the ONP will then be subject to a referendum, organised by Basingstoke and Deane Borough Council. If more than 50% of those who vote agree with the plan, then it will be passed to Basingstoke and Deane Borough Council with a request it is adopted. Once adopted, the ONP will become part of the Development Plan for the area.

Appendices

[This page is intentionally blank]

Appendix I: Regulatory requirements

Annex I of the SEA Directive prescribes the information that must be contained in the SA Report; however, interpretation of Annex I is not straightforward. The table below 'interprets' Annex I requirements.

Annex 1

The report must include...

(a) an outline of the contents, main objectives of the plan and relationship with other relevant plans and programmes;
(b) the relevant aspects of the current state of the environment and the likely evolution thereof without implementation of the plan
(c) the environmental characteristics of areas likely to be significantly affected;
(d) any existing environmental problems which are relevant to the plan or programme including, in particular, those relating to any areas of a particular environmental importance, such as areas designated pursuant to Directives 79/409/EEC and 92/43/EEC;
(e) the environmental protection objectives, established at international, Community or Member State level, which are relevant to the plan and the way those objectives and any environmental considerations have been taken into account during its preparation;
(f) the likely significant effects on the environment including on issues such as biodiversity, population, human health, fauna, flora, soil, water, air, climatic factors, material assets, cultural heritage including architectural and archaeological heritage, landscape and the interrelationship between the above factors;
(g) the measures envisaged to prevent, reduce and as fully as possible offset any significant adverse effects on the environment of implementing the plan;
(h) an outline of the reasons for selecting the alternatives dealt with and a description of how the assessment was undertaken including any difficulties (such as technical deficiencies or lack of know-how) encountered in compiling the required information
(i) a description of the measures envisaged concerning monitoring.

Interpretation of Annex I

The report must include...

An outline of the contents, main objectives of the plan and relationship with other relevant plans and programmes	i.e. answer - <i>What's the Plan seeking to achieve?</i>	i.e. answer - <i>What's the scope of the SA?</i>
Any existing environmental problems which are relevant to the plan including, in particular, those relating to any areas of a particular environmental importance	i.e. answer - <i>What's the 'context'?</i>	
The relevant environmental protection objectives, established at international or national level	i.e. answer - <i>What's the 'baseline'?</i>	
The relevant aspects of the current state of the environment and the likely evolution thereof without implementation of the plan'		
The environmental characteristics of areas likely to be significantly affected	i.e. answer - <i>What are the key issues & objectives?</i>	
Any existing environmental problems which are relevant to the plan including, in particular, those relating to any areas of a particular environmental importance		
Key environmental problems / issues and objectives that should be a focus of appraisal		
An outline of the reasons for selecting the alternatives dealt with (i.e. an explanation of the 'reasonableness of the approach)	i.e. answer - <i>What has Plan-making / SA involved up to this point?</i>	
The likely significant effects associated with alternatives, including on issues such as... ... and an outline of the reasons for selecting the preferred approach in light of the alternatives considered / a description of how environmental objectives and considerations are reflected in the draft plan.		
The likely significant effects associated with the draft plan	i.e. answer - <i>What are the appraisal findings at this current stage?</i>	
The measures envisaged to prevent, reduce and as fully as possible offset any significant adverse effects of implementing the draft plan		
A description of the measures envisaged concerning monitoring	i.e. answer - <i>What happens next?</i>	

[This page is intentionally blank]

Appendix II: SA Framework

SA Topic	SA Objectives	SA appraisal Questions:
Biodiversity	Protect and enhance all biodiversity and geological features	<p>Will the option/proposal help to:</p> <ul style="list-style-type: none"> • Support continued improvements to the status of the River Test SSSI? • Support continued improvements to the status of the Micheldever Spoil Heaps SSSI? • Protect and enhance the integrity of the SINCs present in the plan area? • Protect and enhance semi-natural habitats? • Protect and enhance priority habitats, and the habitat of priority species? • Achieve a net gain in biodiversity? • Support access to, interpretation and understanding of biodiversity and geodiversity?
Climate change	Promote climate change mitigation in Overton	<p>Will the option/proposal help to:</p> <ul style="list-style-type: none"> • Limit the increase in the carbon footprint of the plan area from population growth? • Promote the use of sustainable modes of transport, including walking, cycling and public transport? • Reduce the need to travel? • Increase number of new developments meeting sustainable design criteria? • Improve green infrastructure networks in the plan area to support adaptation to the potential effects of climate change? • Generate energy from low or zero carbon sources? • Reduce energy consumption from non-renewable resources?
	Support the resilience of Overton to the potential effects of climate change	<p>Will the option/proposal help to:</p> <ul style="list-style-type: none"> • Ensure that no development takes place in areas at higher risk of flooding, taking into the likely effects of climate change into account? • Sustainably manage water run-off, ensuring that the risk of flooding is not increased (either within the plan area or downstream) and where possible reduce flood risk? • Ensure the potential risks associated with climate change are considered through new development in the plan area? • Increase the resilience of biodiversity in the plan area to the effects of climate change?
Historic environment and landscape	Protect, maintain and enhance Overton's cultural heritage resource, including its historic environment and archaeological assets.	<p>Will the option/proposal help to:</p> <ul style="list-style-type: none"> • Preserve and enhance the setting of cultural heritage assets? • Support the integrity of the Overton Conservation Area? • Preserve and enhance buildings and structures of architectural or historic interest? • Protect the historic settlement pattern of the villages and hamlets in the plan area? • Conserve and enhance local diversity and distinctiveness? • Support access to, interpretation and understanding of the historic environment?

SA Topic	SA Objectives	SA appraisal Questions:
	Protect and enhance the character and quality of landscapes and townscapes.	Will the option/proposal help to: <ul style="list-style-type: none"> • Support the integrity of the North Wessex Downs AONB? • Protect and enhance landscape and townscape features?
Land, soil and water resources	Ensure the more efficient use of land.	Will the option/proposal help to: <ul style="list-style-type: none"> • Promote the use of previously developed land? • Avoid the development of the best and most versatile agricultural land, in particular Grade 2 and Grade 3a agricultural land?
	Promote sustainable waste management solutions that encourage the reduction, re-use and recycling of waste.	Will the option/proposal help to: <ul style="list-style-type: none"> • Reduce the amount of waste produced? • Move waste up the waste hierarchy? • Maximise opportunities for local management of waste in order to minimise export of waste to areas outside? • Encourage recycling of materials and minimise consumption of resources during construction?
	Use and manage water resources in a sustainable manner.	Will the option/proposal help to: <ul style="list-style-type: none"> • Support improvements to water quality? • Minimise water consumption? • Protect groundwater resources?
Population and community	Cater for existing and future residents' needs as well as the needs of different groups in the community, and improve equality of access to local, high-quality community services and facilities.	Will the option/proposal help to... <ul style="list-style-type: none"> • Tackle the causes of poverty and deprivation? • Encourage and promote social cohesion and encourage active involvement of local people in community activities? • Increase the ability of 'hard-to-reach' groups to influence decisions? • Minimise fuel poverty? • Maintain or enhance the quality of life of existing local residents? • Promote the development of a range of high quality, accessible community, cultural and leisure facilities?
	Reduce poverty and deprivation and promote more inclusive and self-contained communities.	<ul style="list-style-type: none"> • Improve the availability and accessibility of key local facilities, including specialist services for disabled and older people? • Provide a range of housing
	Provide everyone with the opportunity to live in good quality, affordable housing, and ensure an appropriate mix of dwelling sizes, types and tenures.	Will the option/proposal help to... <ul style="list-style-type: none"> • Provide an adequate supply of affordable housing? • Support the provision of a range of house types and sizes? • Meet the needs of all sectors of the community? • Provide quality and flexible homes that meet people's needs? • Ensure that best use is made of the existing housing stock? • Promote the use of sustainable building techniques, including use of sustainable building materials in construction? • Provide housing in sustainable locations that allow easy access to a range of local services and facilities? • Achieve minimum housing requirements?

SA Topic	SA Objectives	SA appraisal Questions:
Health and wellbeing	Improve the health and well-being of Overton's residents.	<p>Will the option/proposal help to:</p> <ul style="list-style-type: none"> • Promote accessibility to a range of leisure, health and community facilities, for all age groups? • Encourage healthy lifestyles and reduce health inequalities? • Provide and enhance the provision of community access to green infrastructure, in accordance with national standards? • Improve access to the countryside for recreation?
Transportation	Promote sustainable transport use and reduce the need to travel.	<p>Will the option/proposal help to:</p> <ul style="list-style-type: none"> • Reduce the need to travel through sustainable patterns of land use and development? • Encourage modal shift to more sustainable forms of travel? • Enable transport infrastructure improvements?
Economy and enterprise	Enhance the vitality and viability of the Neighbourhood Area	<p>Will the option/proposal help to:</p> <ul style="list-style-type: none"> • Protect and enhance the community offer of Overton and the range of services and facilities available? • Support the economy of the Neighbourhood Area and provide access to employment opportunities?

ABOUT AECOM

In a complex and unpredictable world, where growing demands have to be met with finite resources, AECOM brings experience gained from improving quality of life in hundreds of places.

We bring together economists, planners, engineers, designers and project managers to work on projects at every scale. We engineer energy efficient buildings and we build new links between cities. We design new communities and regenerate existing ones. We are the first whole environments business, going beyond buildings and infrastructure.

Our Europe teams form an important part of our worldwide network of nearly 100,000 staff in 150 countries. Through 360 ingenuity, we develop pioneering solutions that help our clients to see further and go further.

www.aecom.com

Follow us on Twitter: [@aecom](https://twitter.com/aecom)